

Explore

Life and land from the heart of the Yellowstone Region

FREE

Big Sky

Oct. 30 - Nov. 12, 2015
Volume 6 // Issue #22

Big Sky housing crisis addressed?

Big Sky PBR's three-peat

LPHS volleyball, football storm into playoffs

Gallatin River Task Force
receives Patagonia grant

Back 40: A dog's last hunt



OUTLAW
PARTNERS

explorebigsky.com

TABLE OF CONTENTS

Section 1: News

Outlaw News.....	3
Opinion.....	5
Local.....	7
Montana.....	15

Section 2: Sports, Health, and Environment

Sports.....	17
Business.....	23
Dining.....	25
Health.....	27
Environment.....	30

Section 3: Entertainment & Events, and Outdoors

Entertainment & Events.....	33
Outdoors.....	38
Fun.....	39
Back 40.....	40

7 Big Sky housing crisis addressed?



17 LPHS volleyball, football storm into playoffs

10 Gallatin River Task Force receives Patagonia grant

Back 40: A dog's last hunt

40

Explore

Big Sky



What is this publication?

Explore Big Sky is the local paper for Big Sky, Montana, and a news and lifestyle journal for the Greater Yellowstone Region.



Frequency:
26x/year

Our 2 week shelf-life allows for extensive exposure for our advertisers.

33,000
readership/issue

1 million
annual readership

45 mins.
median time readers spend with an issue

Distribution

 **HUNDREDS OF DROP POINTS**

 **MAILED TO SUBSCRIBERS**
in all 50 states

 **CONTRACTED PLACEMENT**

- Top-tier hotels
- Private mountain clubs
- Luxury transport companies
- Art galleries
- Preferred rack placement in Bozeman/Yellowstone International airport
- Bedside at luxury lodging and recreation properties

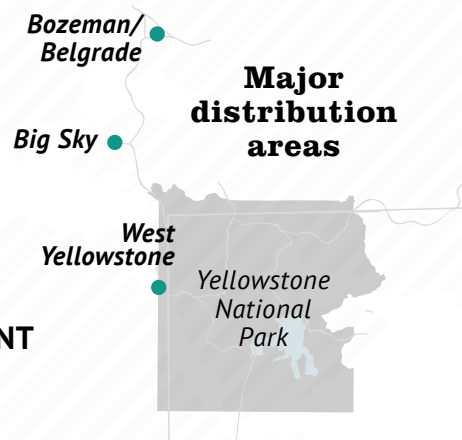

“I’m a greater believer in luck, and I find the harder I work the more I have of it.”

- Thomas Jefferson



News from our publisher, Outlaw Partners

Three-peat Big Sky PBR again honored by world's best bull riders

BY TYLER ALLEN
EBS SENIOR EDITOR

LAS VEGAS – The entertainers behind the Big Sky Pro Bull Riders event again finished their season under the bright lights of the “Entertainment Capital of the World.”

On Oct. 26, the Big Sky PBR was honored as Event of the Year for the third consecutive year at Las Vegas’ Thomas and Mack Center during the PBR Built Ford Tough World Finals. And this year it was no easy feat.

Big Sky’s event was competing against the J.W. Hart Invitational in Decatur, Texas, that hosted a competition called “Unfinished Business.” Eight former riders from the past three decades came out of retirement to compete for a \$160,000 purse on pay-per-view. But it wasn’t enough to unseat Big Sky’s main summer attraction.

“It’s really something special to beat out this event, it was really tough competition,” said Freestone Productions’ Jacey Watson, who produces the Big Sky PBR with her husband Andy, The Outlaw Partners, and Continental Construction. “It’s a hard thing to pull off every year and the community of Big Sky becomes a big part of that.”

In addition to the J.W. Hart Invitational, Big Sky’s signature summer party was up against approximately 150 other PBR-sanctioned events that include the Touring Pro Division and BlueDEF Velocity Tour stops – the Big Sky PBR was elevated to the BlueDEF series in this year’s inaugural season.

Thirty-five of the world’s best riders, many of whom competed in Big Sky on July 30 and 31, vote for the annual Event of the Year.

Sean Gleason, minted as PBR’s new CEO in June, says this award is an opportunity to honor the high production value of the PBR events outside the Built Ford Tough Series.

“[Event of the Year] is to acknowledge all the independent promoters that put in a lot of hard work into events that we can be proud of,” said Gleason, who attended the Big Sky PBR in 2014.

“I thought it was a phenomenal event – well run [and] well produced,” Gleason said. “And in that setting, it’s absolutely gorgeous. I think the riders see a lot of people in the stands and enjoy the community.”

The 2015 Big Sky PBR was Outlaw’s Media and Events Director Ersin Ozer second, but his first opportunity to accept the award in Vegas with Outlaw CEO Eric Ladd.

“It’s such a huge honor, and it’s not one that I take lightly,” said Ozer, adding that he often strolls through Big Sky Town Center arena to exercise his dog Sadie. “When you walk through that empty venue right now, you’d have no idea that three months ago an epic party went down, and one that’s proved to be a memorable experience for cowboys all around the world.”

Ozer was impressed with the BFTS Las Vegas event and took some notes for next year’s Big Sky PBR.

“It was really cool to observe how they put on such a huge production on the Built Ford Tough level,” he

said. “There’s a lot of things that they do well, that we also do ... [like] raising money for charities, and how they incorporate sponsors into the event – it’s very interactive.”

Lone Mountain Ranch was one of the many sponsors involved in the 2015 Big Sky PBR, as the stock sponsor and host of the Golden Buckle VIP tent on July 30.

“It matched all of our expectations and then some,” said LMR General Manager Paul Roberston. “The highlight for us was hosting the community in the Golden Buckle tent, sharing our menu, pouring our drinks, and socializing with the whole town. It’s very rewarding, and the PBR makes it all possible.”

While the producers of the Big Sky PBR are happy about its success on the national stage, they won’t be resting on their laurels in 2016.

“This year we have big plans in store for the cowboys who come out to compete,” Ozer said. “Our goal is to take care of them and their families and develop it into an event that is talked about among the athletes throughout the season.”

Gleason said he hopes to come to Big Sky next year after taking 2015 off, and he sees growth in the event’s future.

“I think that PBR recognizes how special that event is,” Gleason said. “We’re looking at some options to work with the promoters to grow the event and increase its prominence in the PBR schedule.”

Tickets go on sale for the 2016 Big Sky PBR in June 2016, and will be available at bigskypbr.com.



The Big Sky PBR BlueDEF event was selected by the top 35 PBR bull riders in the world as Event of the Year. Pictured left to right are many of those associated with the production: Richard Jones on audio; announcer Brandon Bates; Freestone Productions’ Jacey and Andy Watson; The Outlaw Partners’ Eric Ladd and Ersin Ozer; entertainer Flint Rasmussen; and bullfighter Frank Newsom. PHOTO BY MATT BRENNEMAN/BULL STOCK MEDIA



NEWS IN BRIEF

BY EBS STAFF



Schieffer named director of tourism nonprofit

VOICES OF MONTANA TOURISM

HELENA, MT – Voices of Montana Tourism on Oct. 26 announced Dax Schieffer as the new director to lead the organization as the united voice for Montana’s tourism stakeholders. Schieffer joins Voices following an 18-year career at Big Sky Resort.

“My work at Big Sky has shown me first hand ... how powerful this industry can be for thousands of Montanans and their families who benefit from a strong tourism industry,” Schieffer said.

Schieffer will take over the organization following Mike Garcia, who successfully brought the nonprofit forward in critical policy discussions and in establishing a wide financial base.

“Voices will continue to evolve and adjust to the changing needs and opportunities as travel in Montana

enjoys unprecedented growth,” said Racene Friede, Voices of Montana Tourism chair.

Tourism is one of Montana’s leading industries with more than 11 million visitors in 2014, and supports over 38,000 jobs. Total non-resident spending is expected to surpass \$4 billion in 2015.

Schieffer had an early start in the hospitality industry growing up in Sidney, Mont., and working for a family run restaurant throughout high school. After graduating from Montana State University, he was offered a job at Big Sky Resort in lodging operations.

After being promoted to supervisor in accounting, Scheiffer worked for 10 years in marketing as the resort’s spokesperson and special events manager. For the past five years he has served on the executive leadership team as the director of human resources.

Big Sky recycling site gone Nov. 2

BIG SKY COMMUNITY CORP.

Big Sky’s recycling site will temporarily close on Monday Nov. 2 until a permanent solution is found.

A group of public and private community partners has worked to find a longterm solution for the growing Big Sky community to secure a safe and centralized location to house a permanent recycling center, but has so far been unable to find a suitable location.

Town Center has hosted the current site for the past six years, donating the location and clean-up services during this time. However, its location on a road right of way with increasing traffic, along with upcoming construction projects, it’s no longer a safe, viable solution for Big Sky, according to BSCC Executive Director Ciara Wolfe.

“All the pieces are here [in Big Sky] ... to make a sustainable solution, however these type of partnerships and plans take time to implement,” Wolfe said. The Big Sky community has looked at several temporary sites to host the recycling center until the longterm location is secured, however none of them have worked to date.

Understanding that it takes several different services to fully serve a growing community, Big Sky residents are encouraged to either sign up for curbside recycling through Republic Waste Service by calling (406) 586-0606, or drop their recycling at one of the other Gallatin Solid Waste Management District sites throughout Gallatin County.

All locations are listed at recyclemt.com/sites. Big Sky businesses are encouraged to contact Four Corners Recycling at (406) 570-5561 for commercial recycling pickup services.

Opening day in December will be here before you know it.
And when the sun rises that day, it will rise on a whole new world of health care in Big Sky. That’s the day we open

Bozeman Health Big Sky Medical Center.
Emergency services, all day, every day. Helipad for emergency transport.
Inpatient hospital care. Laboratory services.
Diagnostic imaging, including CT scans,

ultrasound, and MRI. Laboratory. Pharmacy.
And Primary Care providers to coordinate care for you and your family.
Bozeman Health Big Sky Medical Center.
The next big thing is almost now.





At the October 22 housing meeting, it was confirmed that Big Sky has a major affordable housing crisis. What do you see as a solution?



Mina Turturica, *Big Sky, Mont.*
Private housekeeper

"They should build more employee housing, not like the condos just built in Town Center – those are too expensive. More like the Mountain Lodge up at the resort but with better facilities, something clean and affordable. I heard Mountain Lodge had bed bugs. If employers offer you housing, it should be clean and safe to live in, but of course there aren't many employers in Big Sky that offer housing anyway."

Follow up: Who are "they"?

"The resort. The ones that actually own Big Sky Resort, it's their job to secure employees with everything."



Nancy Johnsen, *Big Sky, Mont.*
Owner, Choppers Grub & Pub

"We as business owners recognize and are affected by the housing situation firsthand. It's harder to find employees because of it. I think the big players in the community, such as Big Sky Resort, Spanish Peaks and Yellowstone Club; need to step up and build employee-housing units. Developers in the area also need to consider more affordable real estate for working-class, year round residents. The current [housing] options, affordable or not, are so restricted with HOA rules."



Daniel and Jacqueline Cook, *Foresthill, Calif.*
Both self-employed

Daniel: "Give some incentives for developers to build affordable housing and infrastructure, whether it be tax breaks or some other form of incentive. For every one dollar of profit a developer makes on a higher-end development, a certain percentage of that dollar should go back into affordable housing projects that yield lower profit margins. That should be a requirement to come and build here."

Jacqueline: "If a developer wants to make significant profit from this community, is it not an obligation to return a portion of that profit back into the community that is being burdened by their development? This could include affordable housing that is environmentally sustainable – [using techniques] similar to LEED certification [and] solar."

Letters: Equal coverage for volleyball

I wish to congratulate our Lone Peak High School volleyball team for going into the District 8C tournament in fourth place out of 11 teams! For those unable to attend the Oct. 24 game against White Sulphur Springs, you missed a phenomenal display of skill, precision, and passion. Our team has made giant strides this season thanks to the dedication of the girls, their families and their coaches.

I look forward to following their successes as they begin Districts this coming week, but unless I go to a game myself, I will have to rely on word of mouth on how they are doing. And I ask why is that?

Why does our local newspaper, Explore Big Sky, report on and offer three full pages of coverage (Sept. 18) of our talented football teams' successes, yet that same issue offers only a schedule of our volleyball teams? Do they not deserve the same respect, consideration, and time? Have they worked any less hard than our football players? I would like to see more coverage of our local volleyball teams.

To Luisa, Kuka, Bryn, Bianca, Bella, KP, Solae, Julia, Maria, Carter, as well as our junior varsity girls: Job well done! You are amazing athletes and young women. Good luck as you go into the District, Divisional, and yes, State tournaments!

Angie DeWispelaere
Big Sky, MT



Giant Used Book Sale!

Tuesday, Nov. 10 8:30am-5:00 pm **Wednesday, Nov. 11** 8:30 - 11:30am.

in the new elementary school gym!



hours:

Sunday 1-5p.m.
Monday 10a.m.-6p.m.
(Toddlers Storytime 10:30 a.m.)
Tuesday 4-8p.m.
Wednesday 4-8p.m.
Closed Thursday-Saturday

Public Computers
available here.
All are welcome.

Located at the
north end of
Ophir School



Rocky Mountain Elk: *Cervus canadensis nelsoni*



Did you Know?

Elk are one of the largest species within the Cervidae or deer family in the world, and one of the largest land mammals in North America and eastern Asia. Montana has an elk population of 150,000, the second largest in the U.S.

Repect. Protect. Cherish.

Paid for by the animals in your backyard.

SKYLINE

LINK TO THE PEAK!

LET MOBILE ADVERTISING DRIVE BUSINESS TO YOU!

BUS WRAPS AVAILABLE - Target thousands of local consumers including Resort employees, permanent residents, MSU Students and 300,000 seasonal tourists

CONTACT OUTLAW PARTNERS (406) 995-2055 OR MEDIA@THEOUTLAWPARTNERS.COM

BIG SKY'S TEXTILE CLEANING SPECIALIST SINCE 1988

ANDERSON

ENTERPRISES

Our Mission: To provide the best possible service to our clients through education, experience, courtesy, honesty and professionalism.

CLEANING SERVICES:

Textiles • Carpets • Soil and stain protectants • Spots • Upholstery
Leather • Fine area rugs • Tile and grout • Specialty countertops
Hardwood floor cleaning & conditioning • Odor Removal

IICRC CERTIFIED FIRM

(406) 995-2811

BERKSHIRE HATHAWAY
HomeServices
Montana Properties

Big Sky

BIG LIFESTYLE

BHHSMT.COM | 406.995.4060 | 55 LONE PEAK DRIVE | BIG SKY TOWN CENTER

\$13,750,000 | #205500 | Call Stacy or Eric

JACK CREEK ROAD
Located between Ennis and Big Sky. 1,916± acres, via a private gated road. The Ranch includes a custom log home and other building locations. Co-listed with Swan Land Co.

\$8,350,000 | #208912 | Call Stacy or Eric

CAMP ARROWHEAD
25± acre Beehive Basin compound. House, guest house, caretaker apartment. Views to Lone Mountain, Andesite and Beehive. Near Big Sky Resort and Moonlight Basin.

\$2,750,000 | #208466 | Call Don

TIMBERLOFT ROAD
120± acres sited in an alpine meadow overlooking Big Sky. Incredible views of the resort area including Lone Mountain. 3 selected home sites each on their own 40± acre parcel.

\$220,000 | #202413 | Call Marc

BLACK OTTER ROAD CONDO
2 bd, 1 full ba condo has a central location in Big Sky. Adjacent to Arnold Palmer designed Big Sky Golf Course, fireplace, exterior patio and access to the Silverbow pool center.

DON PILOTTE MANAGING BROKER, GRI, RRS, SFR 406.580.0155
STACY OSSORIO BROKER 406.539.8553 | **ERIC OSSORIO** BROKER 406.539.9553
TONI DELZER SALES ASSOCIATE 406.570.3195 | **MARC LAUERMANN** SALES ASSOCIATE, ABR, SFR 406.581.8242

© 2015 BHH Affiliates, LLC. An independently owned and operated franchisee of BHH Affiliates, LLC. Berkshire Hathaway HomeServices and the Berkshire Hathaway HomeServices symbol are registered service marks of HomeServices of America, Inc.® Equal Housing Opportunity.

‘Housing team’ presents Big Sky affordable housing plan

Suggests building 18 units

BY JOSEPH T. O’CONNOR
EBS MANAGING EDITOR

BIG SKY – A group of state, regional and local entities hosted more than 100 community members at a town hall-style meeting on Oct. 22 to address what many feel is the preeminent issue in Big Sky: affordable housing.

Held at the Warren Miller Performing Arts Center, the group consisted of the Montana Department of Commerce, Big Sky Chamber of Commerce, Human Resources Development Council, and representatives from two Bozeman-based engineering firms.

The group exhibited a Preliminary Architectural Report – a planning effort rather than a design effort, according to presenters – funded in part by a Community Development Block Grant from the Montana Department of Commerce.

Using information from a 2014 study performed by the consulting firm Economics and Planning Systems based in Colorado, presenters indicated that 83 percent of Big Sky’s workforce commutes from areas including Bozeman, Belgrade, Gallatin Gateway and West Yellowstone.

Talent recruitment is the No. 1 issue facing Big Sky employers, according to Big Sky Chamber of Commerce Executive Director Kitty Clemens.

“When 83 percent of our payroll [and] brainpower leaves town every night, that’s not a good economic development model,” Clemens said.

Workers who do live in Big Sky face a massive shortage of housing inventory, and Tracy Menuetz, community development director with the HRDC, indicated that young professionals won’t stick around unless the housing crisis is sorted.

“If [Big Sky] can’t provide housing options, [you’re] at risk of losing them as community members,” Menuetz said at the meeting.

The presentation included statistics showing Big Sky is approximately 1,300 units short of the demand for affordable housing. The report suggested that building 18 condos behind the Big Sky Community Park’s tennis courts will help.

A nearly \$6.5 million price tag hangs on the project (see sidebar for breakdown of potential funding sources).

Tract 2 of the Sweetgrass Hills subdivision scored the highest of the eight properties the presenters deemed feasible, based on criteria including zoning, price per acre, property size and access to public water and sewer services, among others factors.

Bozeman-based architectural firm Comma Q subcontracted consultants from the engineering firms Stahly Engineering and Associates, as well as Morrison-Maierle to perform the PAR. The consultants suggested the preferred option would be to build 18 condos on the 4.14-acre parcel.

Each unit would be 1,300 square feet, and target cost to the buyer would be approximately \$190,000, according to Greg Benjamin, a professional engineer and vice president of Stahly who helped deliver the PAR.

According to the presentation, 82 percent of workers in Big Sky earn less than \$40,000 annually. The area’s median income is approximately \$60,000, according to the final report presented by EPS in July 2014.

For housing to be considered affordable, the U.S. Department of Housing and Urban Development states that a family should not pay more than 30 percent of its annual income on housing.

“Families who pay more than 30 percent of their income for housing are considered cost burdened, and may have difficulty affording necessities such as food, clothing transportation and medical care,” according to HUD’s website.

At HUD’s suggested affordability of 30 percent of AMI, the average Big Sky resident could afford to pay \$18,000 per year on housing. In the last year, the median selling price for a single-family home in the greater Big Sky area, according to the Gallatin Association of Realtors, was \$1.06 million.

The “housing team,” as the Big Sky Chamber of Commerce dubbed this collaboration, will present the same report to Gallatin County Commissioners on Nov. 10.

POTENTIAL FUNDING SOURCES FOR PROPOSED 18 UNIT CONDOS

POTENTIAL REVENUE SOURCES	AMOUNT	ASSUMPTIONS
Community Development Block Grant	\$420,000	Maximum grant with reduced affordable units
Federal Home Loan Bank-AHP	\$280,000	\$20,000 per unit
HOME competitive grants	\$750,000	Maximum grant amount
3 bedroom / 2.5 bathroom	\$2,660,000	Max affordable sales price: \$214,000 target: \$190,000
3 bedroom / 2.5 bathroom	\$1,200,000	Based on current market comparable listings
Shared infastructure costs	\$77,197	10% infastructure costs
Land donation	\$307,500	50% of assumed land costs
Private and community funding	\$786,136	
TOTAL REVENUES: \$6,480,833		

ONLY ADVERTISE ONLINE?
WE’VE GOT NEWS(PAPER) FOR YOU.

EXPLORE BIG SKY NEWSPAPER REACHES

38,500

READERS/ISSUE

WHO SPEND AN AVERAGE OF

45

MINUTES/ISSUE

71%

OF READERS TOLD US THEY ARE LIKELY TO SPEND MONEY WITH OUR ADVERTISERS

(Explore Big Sky reader survey, 2014)

THAT’S 27,335 POTENTIAL CUSTOMERS IN A TARGETED, ENGAGED MARKET.

(YOU’RE WELCOME.)

Explore

Explore Print. Big Sky

media@theoutlawpartners.com | (406) 995-2055

YELLOWSTONE CLUB



Treehouse WML #206 / \$11.5M
2,191 SQ FT



River Runs Through It / \$13M / 13,349 SQ FT



16 Pumice / \$10.5M / 9,103 SQ FT



21 Soapstone / \$9.85M
7,587 SQ FT + guest house

SPANISH PEAKS MOUNTAIN CLUB



2535 Ousel Falls / \$2.95M / 4,071 SQ FT



Ski Tip Lot 8 / \$825K / 1.11 ACRES



Lot 156 Seclusion Point
\$545K / 3.36 ACRES



Lot 148 Wildridge Dr.
\$545K / 3.05 ACRES

BIG SKY



Chief Two Moons
\$649K / 2,315 SQ FT
(to be built residence)



Spanish Peaks Club Condo #11
\$585K / 2,314 SQ FT



Spanish Peaks Club Condo #44
\$549.9K / 2,140 SQ FT



21 Antler Drop Ct.
\$365K / 1,860 SQ FT

BIG SKY



Lot 287A Rising Bull
\$529K / 1.04 ACRES



Joy Road Lot 3 / \$415K / 6.83 ACRES



Elk Ridge Ranch 28
\$399.9K / 39+ ACRES



Lot 43A Half Moon
\$399.9K / 1.22 ACRES

HEBGEN LAKE/ WEST YELLOWSTONE



Yellowstone Ranch Preserve
753 +/- ACRES
Whiskey Jug Cabin
3 bedroom, 2 bathroom / 2,702 SQ FT
+ 9 homesites

Waterfront conservation property near
Yellowstone National Park

\$19,500,000



14 Choke Cherry Lane
\$97.5K / 1.08 ACRES

YELLOWSTONE CLUB



208 Andesite / \$5.9M / 6,312 SQ FT



Lot 338 Bristlecone Drive
\$4.95M / 14.6 ACRES



Lot 332 Upper Cedarview Dr
\$4.4M / 4.6 ACRES



Lot 36A Copper Court
\$3.3M / 5 ACRES

MOONLIGHT BASIN



Luxury Suite 1B / \$1.49M / 2,563 SQ FT

BIG SKY



214 W. Pine Cone Terrace
\$1.5M / 4,268 SQ FT



Buck Ridge Lodge / \$899K / 4,144 SQ FT

BIG SKY



352 Candlelight Meadow Dr.
\$315K / 1,859 SQ FT



Cedar Creek #45 / \$229K / 868 SQ FT



Hill Condo #1253
\$112K / 440 SQ FT



Mountain Meadows
\$3.495 M / 120 ACRES

BIG SKY

BOZEMAN



Lot 3 & 3A Windy Pass
\$399.9K / 5.63 ACRES



Ramshorn Lot 2
\$128.5K / .32 ACRES



512 Old Farm Road
\$3.25M / 5,497 SQ FT, 20+ ACRES / E. Gallatin River Frontage

COMMERCIAL / DEVELOPMENT OPPORTUNITIES

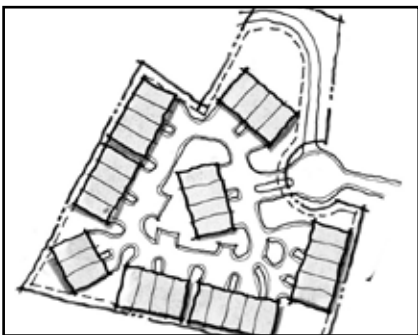

Yellowtail Development / \$2.4M / 3.5+ ACRES



Spruce Cone Development / \$420k
Platted for 3 duplexes



Airport Garages / \$24.9K- \$29.9K each
NOW TAKING RESERVATIONS



Market Place / 5 units available
See agent for details

LKRealEstate.com



All information given is considered reliable, but because it has been supplied by third parties, we cannot represent that it is accurate or complete, and should not be relied upon as such. These offerings are subject to errors, omissions, and changes including price or withdrawal without notice. All rights reserved. Equal Housing Opportunity. If you currently have a listing agreement or buyer broker agreement with another agent, this is not a solicitation to change. ©2014 LK REAL ESTATE, LLC. lkrealestate.com

GRTF receives Patagonia grant

BY AMANDA EGGERT
EBS CONTRIBUTOR

BIG SKY – Local nonprofit Gallatin River Task Force received a \$5,000 grant Oct. 12 from Patagonia’s World Trout Grant Council for a project slated to address erosion and river-access issues on the Upper Gallatin River.

The Moose Creek Habitat and River Access Improvement Project, as it’s known, was recognized by the World Trout Initiative for the positive impact it will have on the Gallatin’s fish population. GRTF joins 170-plus nonprofit conservation groups that have been awarded a total of more than \$1 million dollars from the council in the past decade.

Kristen Gardner, executive director of GRTF, said she hopes the grant will help increase public support – and funding – for the project, which has an estimated price tag of \$300,000.

“We’re ... excited to have Patagonia’s support because it will really enhance our ability to fundraise, and this is a project where we’re going to have to fundraise a lot,” Gardner said.

In partnership with the Custer Gallatin National Forest, GRTF will address problems of riverbank erosion and compromised water quality at the Moose Creek River Access, a site commonly used by fishermen, rafters, kayakers, and campers. According to Gardner, fine sediment loads and stream-bank loss have negatively impacted the aquatic invertebrate population at the site.

The project is still in the planning phase, but overall goals include enhancing streamside vegetation, stabilizing the bank, creating a boat ramp, and installing fences and signs to direct users to focused access trails.



The Gallatin River Task Force on Oct. 12 received \$5,000 from Patagonia’s World Trout Grant Council. The money will help the nonprofit address erosion and access concerns on the Upper Gallatin River at locations like the Moose Creek river access, pictured here. PHOTO BY TYLER ALLEN

Wendi Urie, the recreation program manager for the Bozeman Ranger District, said the U.S. Forest Service will likely use a mix of volunteers, contractors, and Forest Service employees to accomplish these tasks.

Gardner estimates it will take two to three years to complete the project. Urie said a firm breaking-ground date has not been established, but she’s hoping for next fall when there’s a decrease in river flow and public use.

Financing, according to Urie, is one variable affecting the on-the-ground start date. “At the moment, we’re still working on how this would fit into our budgets and what [the Forest Service] can bring to the table in terms of funding,” she said.

The Moose Creek project will be the first collaborative river-access project between GRTF and the Custer Gallatin National Forest. Urie said the Forest Service, which has traditionally been more involved in managing trailheads and campgrounds, is looking forward to the opportunity to address river access and water quality with projects like this one.

“A partnership with a nonprofit like [GRTF] allows us to have a partner that can seek out grants and funding opportunities that wouldn’t be available otherwise,” Urie said.

Gardner said the Patagonia World Trout Grant Council was impressed by the level of collaboration that has gone into this project.

Earlier this year, GRTF mapped 111 river-access sites along the Upper Gallatin, and discussed the condition of some of those sites with stakeholders like Montana Fish, Wildlife and Parks, as well as Trout Unlimited, rafting company owners and recreational users.

Big Sky Resort voted Best Family-Friendly Resort

BY DAVID HEILING
EBS CONTRIBUTOR

BIG SKY – Big Sky Resort has done it again.

Big Sky’s illustrious resort was voted 2015 Best Family-Friendly Resort by onthesnow.com’s Visitor’s Choice Awards on Oct. 15. The recognition adds to Big Sky Resort’s collection of awards including VCAs for 2014 Best Terrain and the Best Overall Resort in 2013 and 2009.

Home to the “Biggest Skiing in America,” Big Sky has been in the national spotlight plenty in 2015. USA Today named Big Sky Resort in its top-10 secluded ski resorts, and SKI magazine ranked Big Sky second in Terrain Variety, sixth in Terrain Challenge and ninth in Scenery.

The Best Family-Friendly Resort designation falls in line with Big Sky’s family-friendly community. Sheila D’Amico, public relations manager at Big Sky Resort, said the award should bring new visitors to the area, boosting the local economy in the process.

“A lot of times [vacationers] want to go to what they know,” D’Amico said. “We want to show that we’re

something new for them. Families who have always gone to Colorado or Utah and haven’t thought of Montana, I think this award will go a long way to bring some of those families ... to Big Sky.”

Big Sky Resort is also family friendly in its low pricing for children. Young ones under the age of 10 ski free when staying in lodging booked through Big Sky Central Reservations. The Kids Club is open daily from 4-6 p.m., and gives children an opportunity to participate in organized activities and make friends while their parents have some free time.

“The whole community of Big Sky, including the resort, is very family oriented,” D’Amico said. “We all cater to kids. I think how Big Sky Resort separates itself from other places is that we are still a great resort that caters to children, yet we aren’t Disneyland.”

The publicity the award brings to Big Sky Resort should drive more traffic to the area, and D’Amico says once families arrive they won’t soon forget their experience.

“Families build memories,” she said. “Once they build memories, they want to relive those memories.”

BIG SKY BUSINESS SERVICES

235 Snowy Mountain Circle, Suite 2
(West Fork Meadows, next to Gallatin Alpine Sports)



Hours

Mon-Fri: 9 – 5:30
Sat: 10 - 3



One-Stop Shipping and Business Center

Shipping, Boxes, Packing Material, Copies, Fax, Computer Rental, Cards, Postcards, Notary, Gifts

Phone: 406-995-7884 Fax: 406-995-7885

P.O. Box 161608, Big Sky, MT 59716-1608

Email: bsbsmt@yahoo.com

Serving Big Sky since 2001!

RAINBOW RANCH LODGE

RELAXATION | CELEBRATION | RECREATION



-RR FALL RESTAURANT HOURS

BREAKFAST Lite Continental Starting October 5th, Public Welcome

RESTAURANT & BAR Open through October 4th, Closed for the Fall, then Reopening November 25th 7-days a Week.

PRIVATE DINNERS AND HOLIDAY PARTY DATES Booking during our seasonal restaurant closure.

BOOK NOW! Events@RainbowRanchBigSky.com

Reserve your place along the river today!

406-995-4132 | Big Sky, Montana | WWW.RAINBOWRANCHBIGSKY.COM

TALLIE LANCEY

Running for the Big Sky Resort Tax Board



Big Sky Resident for 10 years

Former President of the
Arts Council of Big Sky



Contact me at 406-600-8081 with questions

Paid for by Tallie Lancey, PO BOX 160253, Big Sky, MT 59716

Kevin Germain

Candidate
for
Big Sky
Resort Tax Board



I am asking for your vote in the upcoming election for the Big Sky Resort Tax Board. As an active member of the Big Sky Community, I am well-versed in the local issues and uniquely qualified to serve as your representative:

- Board Member of the Big Sky Chamber; Big Sky Mountain Trails, Recreation and Parks Special District; Moonlight Community Foundation; Big Sky Natural Resource Council; Jack Creek Preserve Foundation; and member of the Custer-Gallatin National Forest Working Group
- Avid outdoorsman who loves skiing, fly fishing, trail running, mountain biking, and most of all, spending time with my wife and our 3 school-aged children
- Master's Degree in Civil Engineering & Undergraduate Degree in Geohydrology from MSU

I am committed to supporting initiatives that will improve our growing community, such as affordable housing, improvement and expansion of recreational areas and trails, protection of our natural resources, and the environmental and economic sustainability of our community.

Paid for by Kevin Germain for BSRAD, PO Box 161901, Big Sky, MT 59716



Creighton Block
GALLERY

CREIGHTONBLOCKGALLERY.COM
(406) 993-9400

Town Center, Big Sky, Montana

Julie Chapman "Pensive," Scratchboard, 21 x 12

live**THE**DREAM.





live**THE**DREAM.

Scan to go to our website

LTD REAL ESTATE

REAL, LOCAL KNOWLEDGE THAT WORKS FOR YOU.

LTDrealestate.com | 406.995.2800



910 Sunburst Dr.
2 bedroom / 1 bath
\$236,500 / MLS#205335



Spanish Peaks Mountain Club
Wildridge lot 8, +/- 1.05 acres
\$550,000 / MLS#205683



The Pines Condos, D3
3 bedroom / 2 bath
\$419,000 / MLS# 203360



THE RAM'S HORN



BY DUSTIN SHIPMAN
BSSD SUPERINTENDENT

“The Ram’s Horn” is a regular column by Big Sky School District Superintendent Dustin Shipman, offering news and insight from the district.

Schools across the U.S are faced with many challenges while working to ensure the leaders of tomorrow are prepared for the rest of their lives. One of the most important and widely discussed facets of education in the 21st century is curriculum.

Loosely defined as the courses an educational system offers, this definition falls short of the operational aspects, because curriculum is an all-encompassing concept. Curriculum also refers to the skills a student must demonstrate; the assessments an educator uses to judge those skills; the resources used to reach the institution’s standards; and the teaching strategies used to impart the skills and knowledge needed for students to be successful.

As schools examine curriculum, many questions are raised. First and foremost, it’s important the school system creates programming that’s reflective of community desires regarding student development, and how to ensure the wellbeing of its graduates. A school district also must analyze curriculum to ensure its approaches to learning are contemporary – the content should be organized on a k-12 spectrum with respect to child development, with content and skills that flow seamlessly from year to year.

An additional key to successful programming is to ensure emerging world issues are addressed, incorporating those issues in the curriculum, and presenting them in a way that positively impacts student growth.

One of the greatest challenges facing schools is keeping the curriculum flexible enough to address the ever-changing needs of the 21st century learner. BSSD is committed to providing our students the best education in Montana, and will consider each of these curriculum facets to reach that goal.

Switching gears, Lone Mountain Land Company has graciously offered the use of the private Jack Creek Road for Lone Peak High School sports fans attending events in Ennis. We will announce details of the road access and provide authorization specifics before any competition with Ennis . Requirements will include a waiver of liability, proof of insurance and a copy of a valid driver’s license.





Made In Big Sky
Montana

CALLING ALL BIG SKY AREA ARTISANS

Made in Big Sky is a cooperative and needs your membership!

Call Jean for more info:
406.995.3216









Redefining Used Furniture

www.ufsbozeman.com

406.586.1555 | Follow us on  

19th and Main | Mon-Fri 10-6 • Sat 10-5 • Sun 1-4



The Original Bank of Big Sky



Tim Kent
Commercial Lender and Branch Manager

O: 406.556.3215 | C: 406.223.9573
tkent@bigskybank.com



Brett Evertz
Real Estate Loan Officer

55 Lone Peak Drive | Big Sky, Montana

O: 406.556.3214 | C: 406.629.0132
bevertz@bigskybank.com NMLS #523473

Member FDIC



Equal Housing Lender

achieve a
HEALTHY **MIND
BODY
AND
SPIRIT**



**big sky
HF
HEALTH & FITNESS**

BIG SKY'S ONLY FULL-SERVICE WORKOUT FACILITY

OPEN 5 A.M.-10 P.M. 7 DAYS A WEEK
DAY, WEEK AND YEAR-LONG MEMBERSHIPS AVAILABLE
WWW.BIGSKYHF.COM / INFO@BIGSKYHF.COM

32 MARKET PLACE, MEADOW VILLAGE, BIG SKY (406) 995 4522

CLASSIFIEDS

NOW HIRING

The Corral

CORRAL STEAKHOUSE HIRING LINE-COOKS TODAY! COME ON DOWN!

Ousel & Spur Pizza Co. and Spur Coffee

Now Hiring, for the Winter Season

Full-time, Salaried, Management positions, with Benefits

* Kitchen Manager

* Coffee Shop Manager

Send resumes and contact information to:

ouselandspurpizzaco@gmail.com

Ace Hardware

Ace Hardware in Big Sky looking for temporary laborer. Duties include, but are not limited to: Moving inventory, fixtures, business equipment and other retail and business collateral, setting up and tearing down of retail fixture and décor, and setting up inventory and retail displays from old location (47835 Gallatin Road, Big Sky, Montana) to new store location (1565 Lone Mountain Trail, Big Sky, Montana). There is a requirement and expectation that employee is physically fit and capable of heavy lifting. There is a further presumption by and between employee and employer that employee has no pre-existing health condition(s) which would limit ability to perform and complete all job duties. Work week is based upon a 40 hour work week. You are expected to be in your work area, ready to start work at your scheduled starting time. Hours are recorded on a time-clock system. Base rate of pay is \$12.00 per hour. Contact Ace Hardware at (406) 995-4500 ask for Dan.

Construction: Seeking Journeyman Carpenters

Blue Ribbon Builders is now hiring experienced/skilled journeyman carpenters for full time, year round work in Big Sky. We offer exemplary compensation packages and work environment! Apply online at: <http://blueribbonbuilders.com/employment/>. Or Send resumes to: hr@blueribbonbuilders.com. For more information call 406-995-4574.

Big Sky School District

Big Sky School District is seeking substitute bus drivers and a FT year-round Facilities Assistant/Custodian For more information call Jermy Zier 406-995-4281 or go to www.bssd72.org

Coal mine expansion stalls in lawsuit citing climate change

BY MATTHEW BROWN
ASSOCIATED PRESS

BILLINGS (AP) – The U.S. Interior Department should not have approved the expansion of a southeastern Montana coal mine without taking a closer look at its effect on the environment, a federal judge said Oct. 26 about a lawsuit arguing the government ignored coal’s contributions to climate change.

Environmental groups sued the Interior Department after it approved an expansion of the Spring Creek Coal mine in 2012. The case marks the second time conservationists have used worries over climate change to successfully challenge approval of a coal mine after it had been granted.

But unlike in the previous case involving Colorado mines, U.S. Magistrate Judge Carolyn Ostby did not explicitly name climate change as a factor in her decision. She referred more broadly to air quality and environmental concerns, saying the government had failed to explain its thinking on the issue before granting approval and failed to seek public input.

Ostby said work at the mine near Decker, Mont. will not be shut down immediately. Rather, the judge recommended that federal officials reconsider the environmental effects of the expansion by Wyoming-based Cloud Peak Energy. The mine, which employs about 260 people, is allowed to continue operating in the meantime.

The judge gave the government 180 days to complete its analysis and get public comment before the mine’s approval would be vacated. U.S. District Judge Susan Watters will have the final decision.

The 2,042-acre expansion of the Spring Creek Coal mine added 117 million tons of coal that could be mined, which would allow it to operate through at least 2022, according to court documents. Mining on those parcels already has begun.

Spokesman Rick Curtsinger said the company was disappointed in the judge’s decision and planned to work with federal officials to defend the expansion.

“Spring Creek Mine is an important part of America’s energy supply and Montana’s economy,” Curtsinger said.

The Interior Department’s Office of Surface Mining and Reclamation is the lead defendant in the case. The agency was reviewing the judge’s recommendations, spokesman Christopher Holmes said.

A similar case in which federal officials reconsidered mining plans that were already approved involved the Colowyo and the Trapper mines, both in Colorado. After a re-examination of the Colowyo mine, Interior officials determined that burning coal to produce electricity there had “insignificant impacts” on

national greenhouse gas emissions and moderate effects on emissions in Colorado.

A plaintiff in both cases, New Mexico-based WildEarth Guardians, has mounted an aggressive legal campaign against the coal industry in recent years, challenging decisions affecting 11 mines in five states through a spate of lawsuits.

A decision is pending in a case involving the San Juan coal mine in New Mexico. In September, lawyers for the group contested federal approval of mine plans and coal leases in four states: the Antelope and Black Thunder mines in Wyoming’s Powder River Basin, the El Segundo Mine in New Mexico, the Bowie No. 2 Mine in Colorado and the Skyline Mine in Utah.

WildEarth Guardians’ Jeremy Nichols said Ostby’s recommendation offers “another solid sign that Interior’s coal program is completely off the rails.

“The greenhouse gas emissions do matter, and they need to come up with solutions to limit those emissions,” Nichols said. “In the long term, that’s going to mean keeping coal in the ground.”

Cloud Peak mined more than 17 million tons of coal from Spring Creek last year, including about 4 million tons exported to Asian markets through ports in British Columbia, according to the company’s regulatory filings.

ADVERTISEMENT

October 20, 2015

To the Big Sky & Southern Gallatin County Community:

As we embark upon the upcoming grand opening of Bozeman Health Big Sky Medical Center, we would like to reflect on the efforts that made this important milestone possible and engage the entire Big Sky, West Yellowstone, and southern Gallatin County region in the celebration that is just a few weeks away.

This vision began in 2003 as part of our long range strategic planning process. The Bozeman Health non-profit organization has served southwest Montana for more than 100 years, and has invested in facilities and services to meet the needs of the communities throughout its service area for decades.

In response to stated community need, the Bozeman Health Board of Trustees approved development of the Big Sky Pharmacy in 2004 to fill a much needed gap in service. As growth continued, the Board approved the initial Big Sky land purchase in 2005 as a site for a future medical facility. Throughout the past decade, we continually monitored and evaluated the feasibility and sustainability of launching the planned medical center project. When the resident and visitor population stabilized as the recession subsided, the Bozeman Health Board approved activation of the plan and the \$25 million investment expenditure, and the Big Sky Medical Center became a reality.

The Board and senior management of Bozeman Health are fully committed to the success of Big Sky Medical Center as we work to advance health and provide more care for more people in more places. In addition to new facilities currently under construction,

our integrated health system will also launch a new electronic health record in December that will provide connectivity and enhanced collaboration among all of our medical providers to better facilitate patient experience and personal engagement in improving health. Quality, safety, and sustainability are key elements in everything we do. Providing high quality essential community services is a long term endeavor.

The mission and vision of the Bozeman Health system remains steadfast under the leadership of the community Board of Trustees and senior leadership team who have served this organization throughout its past and recent history. Community leaders have encouraged and supported our efforts as we’ve worked tirelessly to bring this new facility to fruition. Philanthropic minded individuals, grateful patients, and progressive businesses have stepped forward to lend their spirit, leadership, and generous financial support to enhance the original vision and expand the capabilities for the new era of healthcare in our region. We look forward to a long tenure of leading healthcare advancement and being your trusted health partner as we continue to serve this growing community.

We will come together in December for the public grand opening celebration. Please plan to join us, as this is a milestone to be shared by all.

Sincerely,



Julie Jackson, Bozeman Health Board Chair, Bozeman Health Board of Trustees and Senior Management



BOZEMAN HEALTH



Big Sky Resort, in collaboration with Lone Mountain Land Company, is preparing to submit an Overall Development Plan (ODP) for review by the Madison County Planning Board. The ODP accommodates anticipated growth as an extension of the Big Sky Resort Mountain Village, and is envisioned to offer a mix of residential and commercial densities and uses. The ODP is the first step in a series of steps regulated by Madison County to structure development. Once the ODP is approved, the land will be subdivided over time, and the ODP may be refined accordingly.

We welcome your comments pertaining to this plan to the contact below by November 30th at 3pm:

Madison County Planning Board
P.O. Box 278
Virginia City, MT 59755

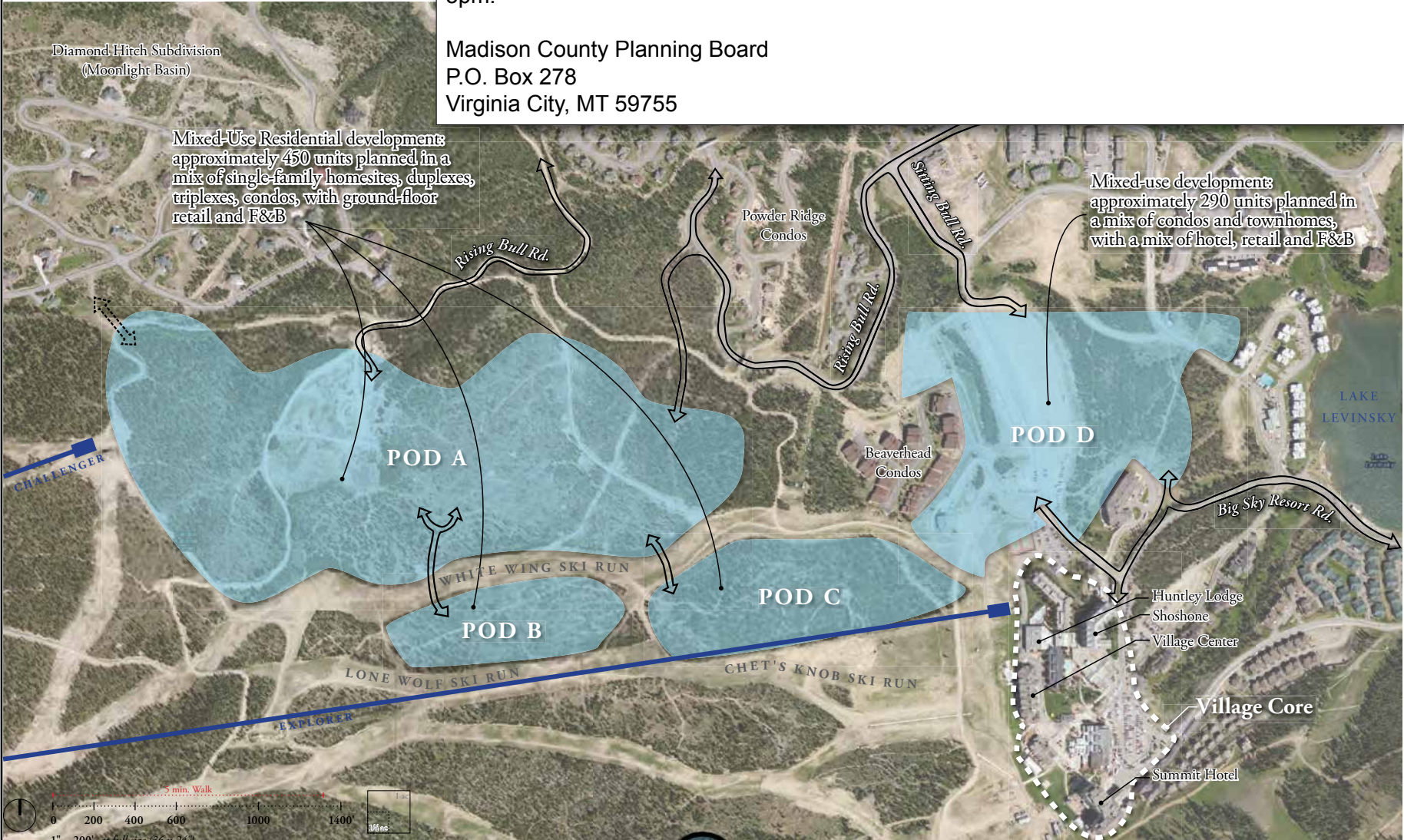

Locals Fishing Report from Gallatin River Guides

Brought to you by Jimmy Armijo-Grover, General Manager



As we move into November many of you have or will be putting your fishing gear away until spring. Some of you never do! Either way I urge all of you to find ways to advance your skills and knowledge over the winter season. Find a good book or two, learn to tie flies (Join us for Thursday Night Fly Tying), practice your knots and watch some YouTube videos on casting and techniques. We stay open all winter, so stop by if you need some direction.

There's no reason for fishing season to ever end around Big Sky, but there are a couple of important dates to keep in mind. November 1st will be the last day to fish in Yellowstone National Park for the 2015 season followed by Montana's general season closure on November 30th. The Montana closure doesn't affect most of the major rivers like the Gallatin, Madison and Yellowstone, but most of their tributaries will close for the season. Make sure to refer to the fishing regulations for more specific information.

For the next month or more many anglers will be focused on areas where they have an increased chance of targeting fish that are preparing or in the process of spawning. And for good reason, it is one of the easiest ways to target big trout. That being said, it is always good to step back and consider some of the consequences of interfering with the trout spawn.

Most importantly these fish are busy ensuring the future of our fishery and the more pressure we put on them the less successful they will be. Secondly many anglers will be wading back and forth over spawning redds that are covered in trout eggs. Fish are very efficient at getting away from predators when they are mature, but just like we have a very vulnerable period as fetuses, trout and other fish are arguably even more vulnerable as eggs and fry. Please take the time to consider what you are walking through and if you suspect that there is a spawning redd in front of you please take an extra few minutes to find a better spot to cross the river or avoid wading as much as possible if you are unsure.

Have a great fall, see you at Thursday Night Fly Tying and stop in with fishing reports as often as possible!

Brownie Sparkle Minnow



CDC Pink Emergers



DOA Cripple Baetis



Pat's Rubber Legs



Quigley's Drowned Midge



Since '84. Fine Purveyors of Fly Fishing Awesome-ness.

GEAR. GUIDES. HONEST INFO.
Serving Big Sky, Yellowstone Park, and Southwest Montana

montanaflyfishing.com • 406-995-2290

Pat Straub; Montana licensed outfitter #7878

Visit our blog for good things: BigSkyFishBlog.com

Section 2:
SPORTS, HEALTH, AND
ENVIRONMENT



Big Horns lock up 2nd place p. 18



Infograph:
American work week p. 24



Pollinating an economic boom p. 30

Big Horn volleyball notches historic season

BY TYLER ALLEN
EBS SENIOR EDITOR

BIG SKY – The Lone Peak High School volleyball team nearly won its 11th straight match on Oct. 24 to secure a third seed in the District 8C tournament.

The Big Horns fell to White Sulphur Spring in Big Sky two matches to three, but still finished with the fifth-year program’s best regular season to date. The 12-4 Big Horns entered the District 8C tournament as the fourth seed on Oct. 29, a day after EBS went to press, to face off with No. 5 Gardiner at Manhattan Christian.

The Big Horns improved from an eighth seed last year, and early in the season it was obvious to LPHS Head Coach Sarah Griffiths that this team was destined to make their mark.

“We had a group of juniors playing together for their third [season] and the chemistry this year clicked,” Griffiths said on the eve of the tournament. “I am truly awestruck about this season so far.”

LPHS recorded a big win early on when they traveled to Shields Valley on Sept. 17 and defeated the Rebels, a team they hadn’t previously beaten in school history, 3-2.

“That really opened [their] eyes as to what was possible, and that they could compete with these teams,” Griffiths said. They also beat three-time defending state champions Gardiner on Sept. 26, another boost to the Big Horn confidence. The team’s 2015 statistics compared to last year demonstrate their improvement.



Bella Butler was fourth with 123. Solae Swanson was second with 103 kills and Bella Butler was fourth with 87.

Among league leaders in aces were Kuka Holder, Luisa Locker and Bianca Godoy, placing seventh (32), eighth (31) and 10th (30), respectively. Kuka Holder was fourth in assists with 174 and Bryn Iskenderian had 159 for sixth best league-wide.

No matter the Big Horns’ result in the divisional tournament, without any seniors on this team Griffiths says next year looks bright for LPHS volleyball.

“I think we’re going to have a great season [and] continue to impress people,” she said.



LPHS increased their kills from 297 to 410; blocks improved from 36 to 44.5; they had 715 digs this season compared to 362 last year; and assists improved from 195 to 403. They also earned significant individual accolades in 2015.

Luisa Locker led the league with 289 digs, Bianca Godoy was fifth with 148, and



The LPHS volleyball team played White Sulphur Springs in Big Sky on Oct. 24. Dressed in pink for breast cancer awareness, the Big Horns lost 3-2 but entered the District 8C tournament as the fourth seed, after posting a 12-4 record this season. PHOTOS BY TORI PINTAR

Big Horns lock up second place in conference

Host Halloween playoff game

BY ACRA SAMUELS
EBS CONTRIBUTOR

ALBERTON/BIG SKY – The Lone Peak High School Big Horns finished second in the Western C Conference and will host a playoff game in Big Sky against Bridger High School on Saturday, Oct. 31.

Big Horns Head Coach Matt Bakken guided LPHS's six-man football team to a 6-1 conference record this year and second place finishes in back-to-back seasons. The Big Horns also went undefeated at home.

LPHS had two offensive explosions in their final regular season games to vault them into the playoffs.

On Oct. 16, the Big Horns traveled to take on the Alberton Panthers under the Friday night lights, and wasted no time getting their offense started.

Just 48 seconds into the game, junior quarterback Eddie Starz raced 19 yards for a touchdown and freshman Milosz Shipman kicked the points after touchdown for an 8-0 Big Horns lead. After a defensive stop by LPHS, junior fullback Bridger Babcock bolted 42 yards for the first of his five touchdown runs on the day. The Big Horns led 52-12 after the first quarter.

The second quarter was all Big Horns. Starz threw an 11-yard touchdown to senior Chase Samuels and then connected twice with junior Devin Quinn for touchdowns of 28 and 18 yards. Shipman converted

on seven of 10 kicks to add 14 points in the first half.

The halftime score was 74-12 and that was how it ended, as LPHS used its entire roster in the second half. The Big Horns had a strong defensive effort led by Starz with an interception and a fumble recovery, and Chase Samuels had a strip and fumble recovery in addition to three sacks.

Sophomores Evan Redmon, Holden Samuels, Jackson Wade and Zach Estes helped hold the Panthers down with sure-handed tackling, repeatedly stopping the Panthers at the line of scrimmage.

On Oct. 24, the Big Horns hosted the Sheridan Panthers on a Senior Day in Big Sky and it was all Big Horns from the opening whistle. The home team pummeled the Panthers 94-0, as all 12 active Big Horn players got into the action.

Quinn led the offense, scoring the first three touchdowns of the game on a 64-yard kickoff return and two punt returns. Starz threw two touchdown passes, the first was a 27 yarder to Holden Samuels and the second was a 15-yard strike to Babcock, who also scored on touchdown runs of 1 and 7 yards.

Chase Samuels scampered 24 yards for a touchdown and his brother Holden threw a touchdown pass to Shipman from 12 yards out. Shipman led all scorers, converting 11 of 12 two-point kicks and adding a



The Big Horn defense shut out the Sheridan Panthers during a 94-0 victory on Oct. 24. PHOTO BY THERESA DA SILVA

touchdown for a total of 28 points. Sophomore Zach Cone also scored, with two touchdown runs from 12 and 22 yards.

The Big Horns' shutout was their second of the season thanks to stifling defense.

The freshmen and sophomore Big Horns also notched a 54-31 junior varsity win in Shields Valley against Tri-Cities back on Oct. 13. LPHS was led by Zach Estes with two touchdown runs; Holden Samuels' three scores; Evan Redmon's fumble recovery for a score; and Zach Cone's touchdown run. The future looks bright for the Big Horns.

LPHS takes the field Saturday, Oct. 31 at 12:50 p.m. as they host the Bridger Scouts for the Big Horns' second home playoff game in team history.



MONTANA'S OWN



BlueCross BlueShield of Montana

With nearly 600 of Montana's very own employees, Blue Cross and Blue Shield of Montana is one of the most loyal employers in town. Since 1940, we've been here when our boys came home from the war, when you first got married, when you had your first baby and when you went through a family health crisis. We've always been here for you. And we pledge we're not going anywhere. We're Montana's own Real Montanans helping you when you need it most. Through it all.

Learn More or Enroll Today

bcbsmt.com | 1.800.447.7828

A division of Health Care Service Corporation, a Mutual Legal Reserve Company, an Independent Licensee of Blue Cross and Blue Shield Association.



SERVING **BIG SKY** for
44 YEARS
IN THE  OF THE *Meadow Village Center*

Locally owned, Locally operated

OPEN 365 DAYS A YEAR

Open 6:30am to 8pm • 406.995.4636



- Located in the Meadow Village Center next to Lone Peak Brewery
- Delivery Service
- Pre-arrival Fridge & Cupboard stocking

BIG SKY SPORTS
SCHEDULE



Volleyball

Sept. 4	Home	Manhattan Christian**	L: 0-3
Sept. 5	Away	@ Harrsion / Willow Creek**	W: 3-1
Sept. 17	Away	@ Shields Valley**	W: 3-2
Sept. 19	Home	Belgrade	L: 1-3
Sept. 25	Away	@ Ennis**	L: 0-3
Sept. 26	Home	Gardiner**	W: 3-1
Oct. 1	Home	West Yellowstone** / Homecoming	W: 3-0
Oct. 10	Home	Twin Bridges**	W: 3-2
Oct. 14	Away	@ West Yellowstone**	W: 3-0
Oct. 15	Away	@ Sheridan	W: 3-0 W: 3-0
Oct. 17	Home	Park High / Senior Night	W: 3-0
Oct. 19	Away	Belgrade	W: 3-1
Oct. 20	Home	Lima	W: 3-0 W: 3-0
Oct. 24	Home	White Sulphur Springs** / Spike for the Cure Benefit	L: 2-3
Oct. 28-31	Away	@ Manhattan Christian District 8C Tournament	TBA

**** District 8c volleyball games**
Past results are varsity only

Ophir MS / LPHS Football

Aug. 28	Away	@ Westby/ Grenora (Mon-Dak)	LPHS	L: 24-54
Sept. 5	Home	West Yellowstone**	LPHS	W: 38-16
Sept. 18	Away	@ Lincoln**	LPHS	W: 50-0
Sept. 25	Away	@ Hot Springs**	LPHS	L: 14-71
Oct. 3	Home	St. Regis** / LPHS Homecoming	LPHS	W: 86-14
Oct. 5	Away	@ Sheridan	OMS	4:00
Oct. 9 or 10	Away	@ Valley Christian (Mis-soula) **	LPHS	W: forfeit
Oct. 12	Away	@ West Yellowstone	OMS	L: 0-59
Oct. 16	Away	@ Alberton**	LPHS	W: 74-12
Oct. 19	Home	Gardiner	OMS	L: 38-39
Oct. 24	Home	Sheridan** / LPHS Senior Parent Day	OMS LPHS	W: 65-32 W: 94-0
Oct. 31	TBD	1 st round state playoffs	LPHS	TBA
Nov. 7	TBD	2 nd round state playoffs	LPHS	TBA
Nov. 14	TBD	Semi-finals state playoffs	LPHS	TBA
Nov. 21	TBD	State Championship Game	LPHS	TBA

****conference games**

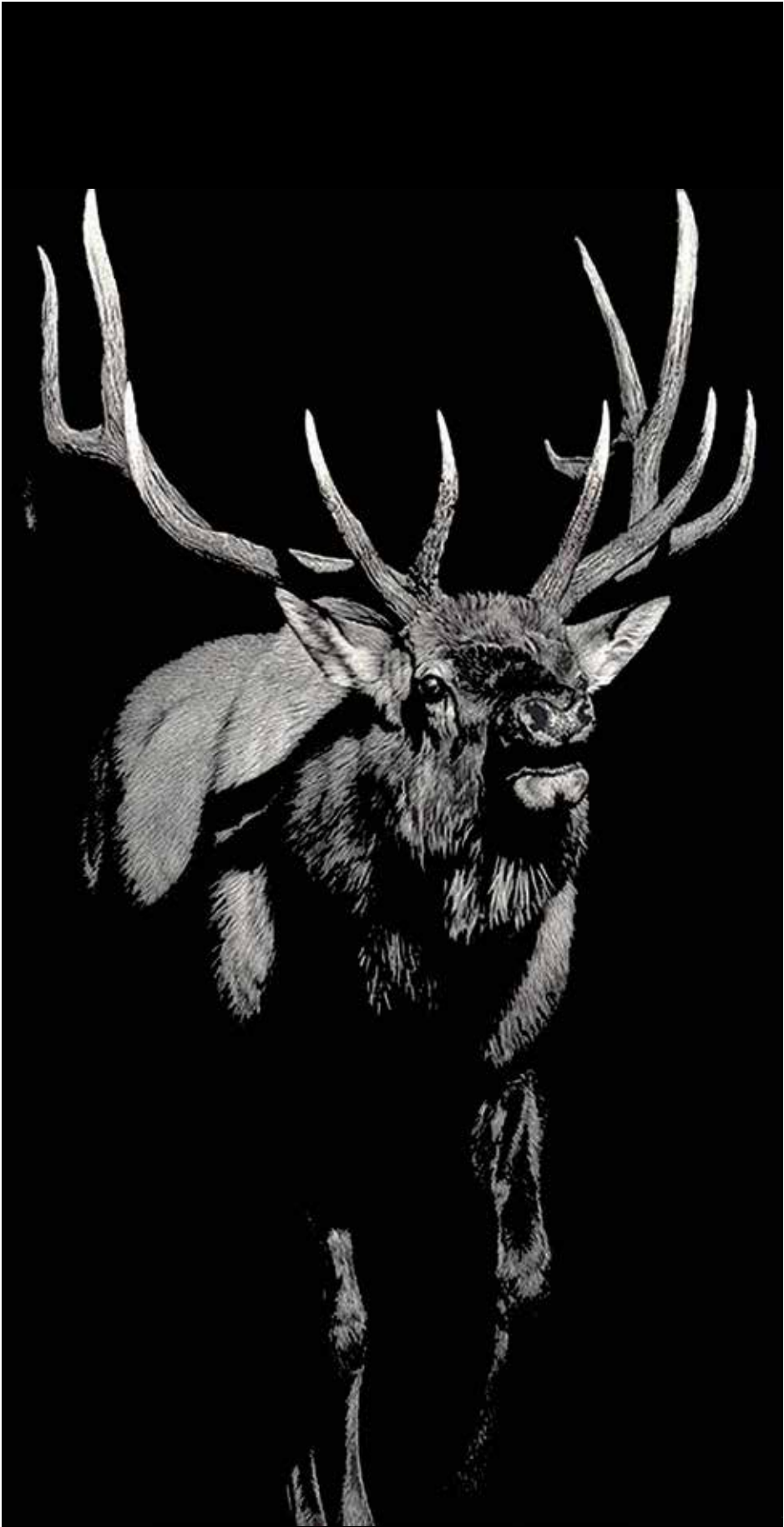

Julie Chapman "Casanova," Scratchboard, 20 x 16

Creighton Block
GALLERY

CREIGHTONBLOCKGALLERY.COM
(406) 993-9400

Town Center, Big Sky, Montana

Ophir Miners lose heartbreaker, finish season with victory

BY ACRA SAMUELS
EBS CONTRIBUTOR

BIG SKY – On Oct. 19, the Miners hosted the Gardiner Bruins in Big Sky, a rematch of Ophir’s second game of the season. The Miners lost to Gardiner 56-37 in September, but the latest contest was a heartbreaker as the Miners fell 39-38.

The Miners quickly dug themselves a 13-0 hole before eighth-grade quarterback Frankie Starz bolted to the end zone to get the home team on the board, 13-6. The teams traded possessions and the Miners threatened when eighth-grader Austin Samuels recovered a fumble in the second quarter, but the Gardiner defense stiffened and the score stood 13-6 at halftime.

Early in the second half, Starz hit eighth-grader Nick Brester from 30 yards out to tie the score at 13. The Bruins quickly answered to take a 19-13 lead but the home team responded with a Brester touchdown run to tie it at 19-19.

The seesaw battle continued as the Bruins scored to take a 25-19 lead. The Miners were stopped on the next offensive drive, but Samuels stripped the ball at the 20-yard line. Brester ran in a touchdown with 6:32 remaining in the fourth quarter to knot the game at 25.

The Bruins again retaliated to take a 32-25 lead, but on the ensuing kickoff seventh-grader Jack Lovely took it the distance to tie the score at 32-all. With 3:31 left, the Bruins took the lead 39-32 with a touchdown and extra point. Brester plunged into the end zone with 1:02 left, but the

home team couldn’t convert the extra point and lost 39-38.

On a cold Big Sky morning on Oct. 24, the Miners took on the Sheridan Panthers. This was the last matchup of the season and the final middle school game for three-year team members Frankie Starz, Austin Samuels and Nick Wade, along with fellow eighth-graders Nick Brester, Max Boman and Alberto Godoy.

Brester started the scoring on a 30-yard touchdown reception from Starz and Brester converted the extra point run for a 7-0 Miners lead. Starz promptly intercepted a Panther pass then threw a 10-yard strike to Samuels on the ensuing drive for a 13-0 lead. After Samuels recovered a fumble on the 18-yard line, Starz found Brester two plays later for a 20-yard touchdown and Samuels converted the Miners’ first two-point kick of the season for a 21-0 lead.

After Samuels blocked a Panther punt, seventh-grade quarterback Evan Iskenderian threw a 20-yard touchdown pass to sixth-grader Aiden Miller with 1:43 left in the first half. But the Miners offense wasn’t done as Iskenderian picked off a Panther pass and took it to the end zone



The Ophir Miners (in blue) playing swarming defense on Oct. 24 against the Sheridan Panthers, during a 65-32 victory in Big Sky. PHOTO BY ACRA SAMUELS

with 49 seconds left. Starz found Brester for the extra point conversion, for a 34-0 lead at the half.

The Panthers ran back the second half kickoff, then scored again to make it 34-13 before the Miner offensive machine got rolling. Starz found Samuels from 25 yards out with 1:21 left in the third quarter to put the Miners up 40-13.

Wade scored on a 5-yard pass from Starz early in the fourth quarter to make it 46-20. After the Panthers cut it to 46-26, Starz ran back the ensuing kickoff to bring the score to 52-26.

Starz completed the scoring by throwing a 5-yard touchdown pass to Samuels and a 20-yard touchdown to Iskenderian – Ophir beat Sheridan 65-32.

The Miners, led by head coach Adam Farr and assistant coaches Chris Samuels and Dan Wade, posted a 3-4 record on the season.



facials



massage



foot & body
treatments

OZssage Spa

15 years looking after Big Sky



Please book ahead so that we can accommodate your requests.

Massage services are available in your home

32 Market Place, Big Sky 406.995.7575 www.ozssage.com

Summer Hours: Monday - Saturday 10:00am - 7:30pm

Despite Portland State loss, Bobcats hope ETSU blowout sparks hot streak

BY COLTER NUANEZ
EBS CONTRIBUTOR

PORTLAND/BOZEMAN – The No. 19 Bobcats hit the road to Portland, Ore. on Oct. 17, for their first matchup at Portland State since 2011 at Providence Park. Montana State's road woes and defensive struggles continued as the No. 12 Vikings rushed for a school-record 465 yards in a 59-42 victory, MSU's third loss of the season.

Mid-October typically brings a bye week for teams in the midst of brutal Big Sky Conference schedules. But Montana State elected to take a September bye in the season's second week. Four games into the Big Sky slate and with four left in conference play, the Bobcats instead played a non-conference game on Oct. 24 against a completely overmatched East Tennessee State squad.

ETSU is a fledgling Football Championship Subdivision program – the Buccaneers had football until 2003 before cutting the sport for 12 years – and the visitors were at a disadvantage from the opening kickoff. ETSU has more than 80 freshmen on its roster and entered the contest with six straight losses. The Bobcats on the other hand have 17 seniors along with a star-studded junior class that includes captains quarterback Dakota Prukop and running back Chad Newell.

Montana State scored at will, notching touchdowns on its first five possessions and totaled 49 points before the end of the third quarter. MSU pulled its starters, giving way to the second and third strings as MSU cruised to a 63-7 victory.

After the ETSU game, MSU coach Rob Ash said the opponents on this autumn afternoon didn't concern him. He's only worried about his Bobcats as MSU prepares for the second half of league play.

"Right now it's all about us," Ash said. "I told the team all week that all I really wanted was for us to get better every day this week, and to be better at the end of the game than we were when we started, no matter who we're playing. I think I can safely say we did that."

The evening contained a slew of firsts, from the first career rushing touchdowns for redshirt freshmen running backs Tavon Dodd and Noah James to third-year sophomore Jayshawn Gates' first kick return touchdown. Redshirt freshman safety DeMonte King notched his first interception and junior defensive end Jessie Clark recorded his first career sack.

"The list of firsts today was long," Ash said. "First tackle, first fumble recovered, first touchdown, and a lot of those were by guys



Montana State wide receiver Justin Paige scores an easy touchdown during the Bobcats' 63-7 victory on Oct. 24. PHOTOS BY MIKE COIL

that don't play a lot or maybe are scouts, but they have great passion for the game and love to compete."

Montana State was 4-3 at EBS press time on Oct. 28, but the Bobcats have just three wins over Division I opponents with four games to play. The baseline for playoff eligibility is seven Division I victories, meaning MSU must win its remaining games to earn a fifth playoff berth in the last six seasons.

Montana State's remaining schedule begins with a Halloween date at the University of North Dakota in Grand Forks. The Montana Grizzlies handed North Dakota a 42-16 loss on Oct. 24 in Missoula.

The remainder of MSU's schedule includes home dates against Southern Utah on Nov. 7 and Montana on Nov. 21, and a road trip to Pocatello, Idaho, on Nov. 14 to take on Idaho State.

"Our backs are against the wall," said Newell, MSU's junior captain from Billings. "Straight up, that's how it is. We have to win football games."

Colter Nuanez is the creative director and senior writer for "Skyline Sports" (skylinesportsmt.com), an online newsgathering organization providing cutting edge coverage of Montana State University and Big Sky Conference sports. The award-winning sportswriter has worked for newspapers and magazines across the West and has covered the Big Sky since 2006.



MSU's defense held the overmatched East Tennessee State to seven points during a rout in Bozeman.

Dalton's astonishing development

BY BRANDON NILES
EBS SPORTS COLUMNIST

Few starting quarterbacks in the NFL have been more maligned than Cincinnati's Andy Dalton during the past two off seasons.

The fifth year veteran has started every game for the Bengals since he was selected in the second round in the 2011 draft, but has taken the blame for the Bengals' dismal playoff record during his tenure.

In his first four seasons, Dalton compiled an impressive 40-23-1 record in the regular season. However, his playoff career is far less impressive. Each year as a starter, Dalton has finished with a first game playoff exit, and pundits and fans alike have wondered if he's the kind of quarterback that can ever lead the Bengals to a playoff victory.

Just how bad Dalton has looked during these playoff losses has snowballed matters. In four playoff games, Dalton has completed less than 56 percent of his passes, averaged only 218 yards per game, and thrown one touchdown pass compared to six interceptions.

While getting to the playoffs on a consistent basis has been a welcome change in Cincinnati

since Dalton's arrival, the lack of postseason success is concerning.

This year, however, Dalton seems to have taken the proverbial step forward. Through the first six games of the season, he has completed more than 67 percent of his passes for 1,761 yards and, most impressively, has thrown 14 touchdowns compared to only two interceptions.

Dalton is on pace to set career highs in completion percentage, passing yards, and touchdown passes, and through the first seven weeks of the season, he leads the NFL in passer rating.

Fans are still coming to terms with whether or not Dalton really has turned a corner. After all, he's had regular season success in the past, and that hasn't yet translated into playoff wins for the Bengals.

The Bengals may not win the Super Bowl this season, but Dalton has improved dramatically in key areas of his game to keep the Bengals undefeated through seven weeks. He's stopped locking onto his primary receivers and he's spreading the ball around, making full use of the plentiful weapons at his disposal in the Cincinnati offense.

Dalton looks comfortable in Bengals' Offensive Coordinator Hue Jackson's system, processing his reads quickly and getting the ball off in time. He's been one of the least sacked quarterbacks in the NFL thus far, due to his quicker release and decision-making.

Finally, he's been a monster in the fourth quarter. While his big-moment and crunch-time prowess has been under attack in previous seasons, he's already put together late game heroics this year in victories over the Baltimore Ravens and the Seattle Seahawks.

As the season continues, we'll find out just how good Dalton is, but credit the fifth-year veteran for taking a drastic step forward in 2015, and credit Jackson for the development of his 27-year-old passer out of Texas Christian University. Dalton looks calm, poised, and efficient thus far, and has the Bengals looking like one of the most complete teams in the league.

Come January, there's no reason to suspect that Dalton won't have a chance to prove he can take this team deep into the playoffs. So far, he looks ready to do just that.

Brandon Niles is a longtime fan of football and scotch, and has been writing about sports for the past decade. He is a fantasy football scout for 4for4 Fantasy Football and is co-host of the 2 Guys Podcast.



TRY A BENNY FOR BREAKFAST



WE DELIVER 406.995.2305
OPEN 7 DAYS A WEEK 7AM-10PM
CHECK OUT OUR MENU:
BIGSKYBLUEMOONBAKERY.COM
LOCATED IN WESTFORK PLAZA MALL
BIG SKY, MONTANA

The CORNER OFFICE

Jobanne Bouchard, a former high-tech marketing executive, is a leadership advisor to CEOs, executives and entrepreneurs, as well as an expert in corporate board composition and dynamics. Visit jobannebouchard.com to learn more or download her recently published eBooks “Board Composition” and “Board Basics.”

Humility in leadership



BY JOHANNE BOUCHARD
EBS BUSINESS COLUMNIST

When people ask me what a strong leader’s greatest quality is, I tell them, “humility.”

Humility frees us from the illusion of perfection, empowers individuals, and strengthens leaders. When one is humble, he or she admits mistakes, doesn’t take things personally, and doesn’t get defensive. When you think about the great leaders who truly inspire you, I bet they all are humble at their core.

I was raised to admit when I was wrong. While I was often embarrassed to apologize, I realized it freed me, and not because the situation had passed. Rather it reminded me that I wasn’t perfect. It also helped me consciously not repeat the same mistakes.

Here’s my approach to apologizing gracefully in both personal and business situations:

Accept if you’re in the wrong. You can’t apologize if you’re unable to admit to yourself that you made a mistake – avoid being in denial. The

apology begins with you, which is humbling especially when you are your own harshest critic, a perfectionist or a high achiever.

Consider the ramifications of being prideful.

When you make a mistake with a business partner, prospect or customer, think about the ripple effects of being prideful and not apologizing. Owning up to a mistake can minimize the damage you might have caused. Think beyond the immediate situation to reestablish your credibility and respect.

Apologize quickly. Don’t brush over the situation, and don’t delay apologizing. Being silent and pretending that everything will eventually be forgotten doesn’t benefit you or the recipient of the mistake. It can create the risk of gossip or escalation, either of which can irreparably taint your reputation.

Apologize with sincerity. Find the courage to reach out to the individuals you’ve offended and personally offer the words, “I apologize.” Don’t let anyone else be the messenger.

Offer a token of your appreciation. Apologizing is the first step, the next course of action is to make up for any inconvenience your mistake might have caused.

Examples of appropriate apologies:

- If you’re a restaurant server or owner, and you’ve unintentionally poured wine onto someone’s garment, apologize immediately. Offer to pay for dry cleaning and assure them there will be no charge for their meal.
- If you’re in the hospitality industry and have overbooked accommodations, seating or provisions, immediately notify those affected once you identify the problem. Send a written apology with a gift certificate for more than the value of the original booking.
- As an employer who has humiliated an employee or customer, apologize promptly, and offer a thoughtfully selected gift. Allow them to air their grievances if appropriate, and make sure everyone involved can close the loop to move ahead without resentment.

When you’re in the wrong, do everything common sense allows to show respect for the wronged parties and to minimize the negative ripple effects – it is possible to regain trust. You shouldn’t be embarrassed by humility, but you should be embarrassed if you don’t apologize.

ARCHITECT'S WIFE CURATED COLLECTIONS

FURNITURE

LIGHTING

DECOR

The Architect’s Wife houses a curated collection of home furnishings that range from sourced luxuries to antique rarities. From rich aniline leather sofas to grand chandeliers that command a room, to delicate plates with exquisite gold trim, each item tells a story of careful craftsmanship and individuality.

Or go totally custom utilizing an extensive fabric, flooring, and wall-covering library.



Located in the historic Montana Motor Supply Building at 23 W. Babcock | Architectswife.com
hello@architectswife.com | 406.577.2000 | Mon-Sat 10am-6pm, Closed Sun

Designer Abby Hetherington has opened a retail space that showcases the breadth and energy of her inimitable design aesthetic. Abby’s eponymous design firm is connected to The Architect’s Wife, giving customers the option to tap into her signature style. Design services are available through Abby Hetherington Interiors. 406.404.1330 | abbyhetheringtoninteriors.com



The American Work Week

A precarious balance of time and productivity



BY TAYLOR-ANN SMITH
EBS GRAPHIC DESIGNER

Since Sweden recently decided to nationally implement a 6-hour workday, the topic of “less is more” in the workplace has become one of health, economics and productivity.

Researchers from the University College London recently found that those working 55 hours or more per week had a 33 percent greater risk of stroke than those working a more balanced 35–40 hours per week. And working these longer hours also showed a 13 percent increased risk of developing coronary heart disease.

Working fewer hours presents several advantages for both employer and employee. One is the opportunity to lessen the effects of

overwork and to enhance the quality of work by reducing drudgery that eventually extends creativity.

A 2013 Gallup Poll found that only 30 percent of American employees felt occupied or enthused by their jobs, while the other 70 percent were not utilizing their full potential at work.

Linus Feldt, CEO of Stockholm, Sweden-based app developer Filimundus, adopted the 6-hour workday in his company last year. His reports show that productivity has stayed the same, he sees fewer staff conflicts, and profits have increased by 25 percent.

Myriad businesses are embracing this concept as leaders for workforce change. Employees for Jason Fried, CEO of Basecamp, work four-day,

32-hour weeks for half the year; Jay Love of Slingshot SEO reports his employee retention rate increased when he phased in three-day weekends; and technology startup Schoolinks implemented the four-day workweek to relieve workplace stress.

CEO Ryan Carson explained why his online-education company Treehouse implemented a four-day, 32-hour week, in a short Atlantic video in June.

“You get all day Friday off, instead of pretending like you’re working when you’re not,” Carson said. “... It may be a little crazy, but just remember, you only have 2,000 weekends, and then you die.”

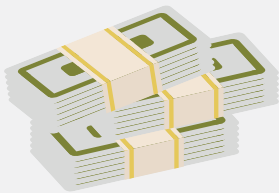

Discontent caused by excessive work hours costs U.S. companies up to

\$550 BILLION
per year

30%
/
70%

30% of American employees felt occupied or enthused at work, 70% felt they weren’t utilizing their full potential



HAPPY EMPLOYEES ARE
12% MORE PRODUCTIVE

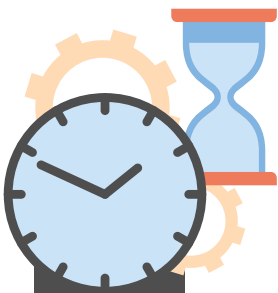

46.7
hours

average workweek in America

37.2
hours

average workweek in European Union (28 countries)

2-3
hours

average daily time American workers spend distracted or wasting time



Average vacation days per year:

USA: 13
Canada: 15
UK: 29
Germany: 35
France: 36
Italy: 40

Paid maternity leave*

*by law

Germany
98 days



France
112 days

Australia
126 days

Approximately **16% of employers** in America offer fully paid maternity leave

“When there’s less time to work, there’s less time to waste.”

-software CEO Jason Fried

SOURCES:
FORBES.COM/SITES/CHERYLSNAPPCONNER/2015/07/31/WASTING-TIME-AT-WORK-THE-EPIDEMIC-CONTINUES/
GALLUP.COM/POLL/165269/WORLDWIDE-EMPLOYEES-ENGAGED-WORK.ASPX
FASTCOMPANY.COM/3048751/THE-FUTURE-OF-WORK/HAPPY-EMPLOYEES-ARE-12-MORE-PRODUCTIVE-AT-WORK
THEATLANTIC.COM/BUSINESS/ARCHIVE/2014/08/WHERE-THE-FIVE-DAY-WORKWEEK-CAME-FROM/378870/

BLS.GOV/NEWS.RELEASE/PDF/ATUS.PDF
THEATLANTIC.COM/BUSINESS/ARCHIVE/2014/12/THE-WASTED-WORKDAY/383380/
WOMENANDTECH.COM/INFOGRAPHIC-PAID-MATERNITY-LEAVE/
CIENCEALERT.COM/SWEDEN-IS-SHIFTING-TO-A-6-HOUR-WORKDAY

AMUSE-BOUCHE

Amuse-bouche refers to an appetizer, and by French translation means, “to entertain the mouth.” It offers a glimpse into what you should expect from a meal. Also it’s free, compliments of the chef.

Time for a field trip



BY SCOTT MECHURA
EBS FOOD COLUMNIST

There is a saying that everything you need to know as an adult, you learned in kindergarten. Do field trips fall into that category?

A few weeks ago, a handful of the Buck’s T-4 team took what we’re calling a field trip. I’m talking about an all-riding-in-a-van, midday break with a packed picnic lunch; a trip where everyone sticks together and has fun but learns something along the way.

We value our relationships at Buck’s, and that includes the men and women who provide us with such essential items as beef, fish and libations.

We started off our day with a 6 a.m. departure, an impressive feat in and of itself. After all, we aren’t part of the golf world, say, which routinely starts its day during what I call rooster hours, but rather food and beverage professionals who end our days polishing glassware or scrubbing stoves when most others are well into R.E.M. sleep.

We arrived at Nelson’s Spring Creek Ranch on a crisp Paradise Valley morning around 8 a.m. Trent Mack, our trout supplier from Trout Culture, had just begun his harvest. Upon seeing us, he took a break from his duties of feeding and harvesting the fish to tell us about the history of the farm and what his day consists of.

Herdinɡ trout to net can prove frustrating as we witnessed, particularly when the fish organize themselves and collectively knock the holding screen out and escape back into the main pool. But it’s a labor of love for Mack. One of us commented that harvesting fish in early morning cold water is a formidable task, but Mack reminded us that it’s no less challenging than when it’s 18 below.

Roger Nelson, the ranch’s fourth generation landowner, also greeted us that morning. He thanked us for taking the time to visit the farm, and off he went for his morning pond-inspection rounds.

We then headed to Columbus, Mont., to a federally inspected processing plant. Another family operated business, Stillwater Packing Co. processes a multitude of animals and products. We were allowed to witness the skilled and efficient processing of an entire cow, a glimpse behind the curtain few people, even in the hospitality industry, see.

As we navigated the cold hallways and meat lockers, and whispered a few horror movie references to each other, we made our way to the butchering area where entire sides of beef are broken down – a term for butchering a carcass – by one man with the ease of you or I buttering our morning toast.

We found new respect for the men and women that work in a refrigerated room, lifting heavy carcasses, breaking them down, and packaging them into weighty boxes for shipment, only to scrub down their workspace like a hospital, and begin the entire process again the next day.

After a picnic lunch along the Yellowstone River, it was off to our final stop: Katabatic Brewing Co. in Livingston.

Named for the cold winds that usher Livingstonians into doorways most of the winter, Katabatic welcomed our group warmly with a 30-minute tour followed by a tasting. Having just opened in September 2014, the brewery is finding the success it hoped for. LaNette Jones, one of the owners, went through the brewing process in thorough detail, and we ended the field trip with a thorough sampling.

Whatever your interests, hobbies, or occupations are as adults, the field trip process, in my opinion, should never end. I’m just lucky and proud to work with a team that’s all about packing a picnic and piling in the van as much as I am.

Scott Mechura has spent a life in the hospitality industry. He is a former certified beer judge and currently the Executive Chef at Buck’s T-4 Lodge in Big Sky.

Find relief

Naturally

- Organic Products
 - Edibles / Tinctures
 - Pectin Strips
 - High CBD Medical Products
 - Vaporizer Oil Pens
 - THC Infused Salves & Creams
-
- Delivery Available
 - Veteran Discounts
 - Open 7 days a week

Learn more at: montanabuds.com

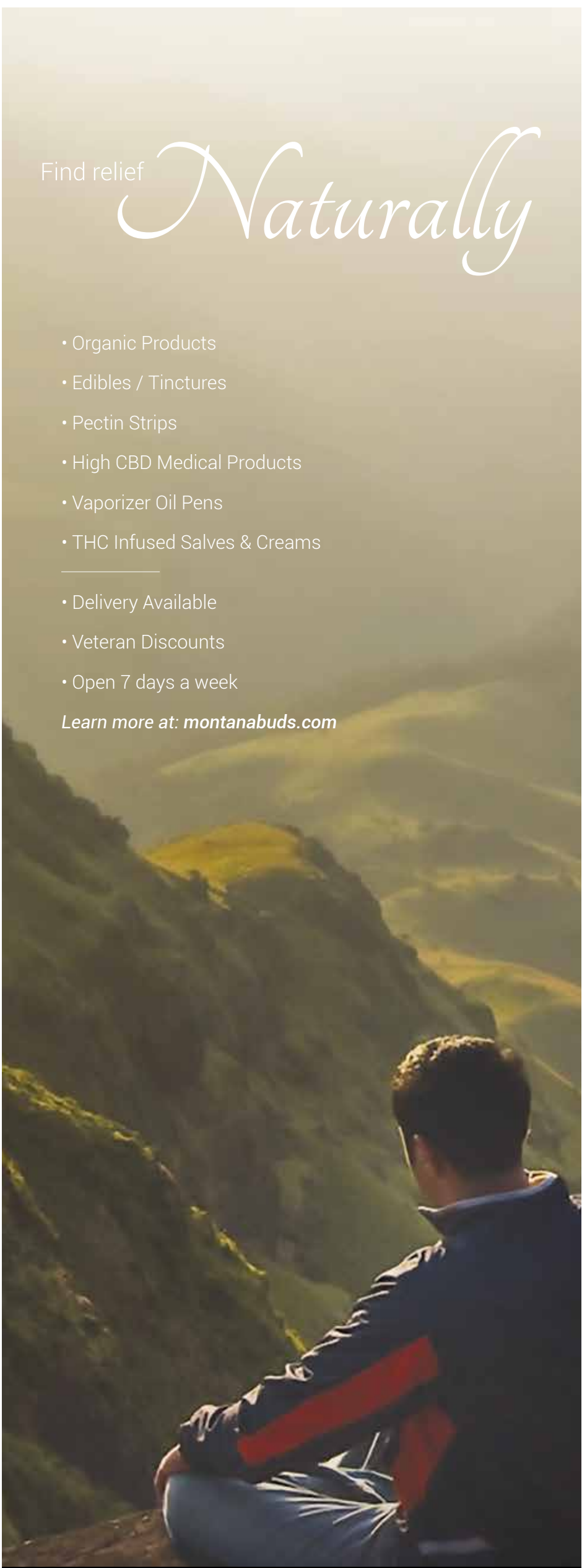

Consistent. Reliable. Delicious
**MONTANA
BUDS**

77 Aspen Leaf Dr. Unit 14B | Big Sky, MT
406.995.BUDS (2837)

'Feast' for foodies

Bozeman's new south-side restaurant offers bistro experience

BY KATIE THOMAS
EBS CONTRIBUTOR

What does “fusion bistro” mean to you? How about “raw bar”? Those questions make the average Montana foodie, like myself, curious.

Feast Raw Bar and Bistro is Bozeman's newest restaurant, with an intriguing menu and unusual atmosphere. Owners Steve Kuntz and Caroline Doern opened the doors on Oct. 13, and have been hosting epicureans five nights a week ever since.

Prioritizing sustainably farmed or harvested meats and fish, as well as locally-sourced ingredients, Feast's menu is divided into sections: “Raw,” “Vegetable,” “Our Favorites” – both meat and veggie small plates – “Seafood,” and “Meat.” The beer and wine menus offer wide variety and local microbrews, and dessert includes chocolate mousse and ice cream treats.

For those who appreciate a different type of happy hour, Feast offers “\$10 Tuesday”: three fresh oysters and a glass of sparkling wine; “\$1.50 Oyster Happy Hour” on weekdays from 3-5 p.m., or until they're gone; and “\$8 Sunday”: six fried oysters and garlic-herb salt French fries.

I recently had the opportunity to sample a dish from each category on the menu. The “Shellfish Feast,” of raw oysters, clams, shrimp, and marinated crab claws was a light start to a long culinary journey – the oysters especially make one consider relocating to the seaside. The same can be said for the “Mezze Platter” of falafel, grilled eggplant, marinated olive and feta that evoke the Mediterranean.

Next I sampled the kale, pear, Camembert-walnut Pâté, followed by delicious crispy pork belly carnitas with sweet corncakes and tomato jam, and then the subtle spice-glazed Salmon over soba noodles. A bottle of the Kermit Lynch Cuvee, a French Côtes du Rhones, accompanied our meal, which concluded with a

splendid almond cake complemented by orange almond paste and sage crème Anglaise.

The space Feast inhabits is noticeably different from its previous occupant, the popular Seven Sushi. Gone are the open kitchen and typical restaurant floorplan – Feast's owners worked with Bozeman's Hetherinton Design to create a timeless atmosphere, which entails bookcases and curtains woven between tables, as well as nooks and semi-private corners.

One of Feast's most eclectic features is the green backed bar, which illuminates the dining experience when it's lit after sundown. The restaurant has an international feel, with the hushed lighting and din of happy patrons.

Kuntz and Doern are both previous owners of catering companies, with extensive culinary experience between them. Kuntz studied at the Western Culinary Institute in Portland, Ore., before working in San Francisco and then Bozeman, where he started his own catering company, Montana Epicurean.

Doern worked in the food service industry for many years before starting her catering company and personal chef business, Caroline's Catering, and the two met when they shared a catering space.

“We both understand flavors, and have a passion for getting food just right,” Kuntz said. Feast was born out of their shared desire to provide “local, sustainable food that is also extremely high-quality, in a comfortable neighborhood atmosphere,” he added.

Feast feels different from any other restaurant in Bozeman, with its upbeat vibe, excellent service, and spectacular food. Eat up!

Located at 270 West Kagy, Suite C, Feast is open Tuesday through Saturday, from 3-10 p.m. Reservations are recommended.



Some of the delicacies offered at Bozeman's Feast, from top to bottom: oysters, a bison ribeye steak, and garnished scallops. PHOTOS COURTESY OF AMELIA ANNE PHOTOGRAPHY



From Jackie *with love*

Consider a plant-based diet



BY JACKIE RAINFORD
CORCORAN
EBS HEALTH COLUMNIST

Hippocrates, known as “the father of Western medicine,” said more than 2,000 years ago, “All disease begins in the gut.” This is as true today as it was then. So

it’s important to get in tune with your digestive system and consider if a plant-based diet can improve your health.

A few signs of unhealthy digestion include gas and bloating, loose stools, constipation, acid reflux, inflammation (anywhere in the body), throat and nose irritations, food sensitivities, and skin disorders.

Problems in the digestive system can eventually cause our overall health to break down. Here are some potential consequences of this breakdown: autoimmune disorders, food and general allergies, autism, arthritis, diabetes, eczema, and even mental illness.

A major part of improving gut health is eating healing foods on a regular basis. A diet consisting of mainly plants can be excellent for digestive health.

Eating a plant-based diet doesn’t eliminate other foods like meat, cheese or bread, but these are eaten sparingly and plants make up the majority of your nutrition. I recommend organically grown food when possible, to avoid carcinogenic chemicals.

Consider “eating the rainbow” at every meal by adding color to your plate using whole vegetables and fruits. For example, if you’re making a sandwich, add lettuce, tomato, onion and avocado. Enjoy a side salad instead of chips. During breakfast, add colorful fruit to your oatmeal or make a smoothie with greens. At dinner, load your plate with fresh veggies and treat meat like a side dish.

It’s easier than you might think, but if eating this way is a big shift for you, take baby steps so that you enjoy the process and ensure the changes are sustainable. Avoid telling yourself you can never eat certain foods again – unless you have a disease that is triggered by them – because the mind will often crave what it can’t have.

Plants are typically lower in calories than meat and processed foods so make sure that you are eating enough to feel satiated.

The fiber in a plant-based diet will keep food and waste moving smoothly through your system, and help eliminate constipation and diarrhea. But because eating plants is cleansing, the body may take some time to adjust. You might also find that some plants work better for you than others.

If you experience bloating or gas due to the increased amount of fiber, consider these tips: Try nut butters over whole nuts; eat more root vegetables instead of grains; eat more greens like kale and spinach over cruciferous veggies like cauliflower and broccoli; and try hemp hearts or pumpkin seeds over legumes such as black or pinto beans. Experiment and listen to your body.

Other benefits of a plant-based diet include: improved beneficial bacteria in the gut; reduced inflammation, risk of cancer and diabetes; lowered blood pressure; and potential weight loss.

Enjoy the rainbow on your plate.

Jackie Rainford Corcoran is an IIN Certified Holistic Health Coach, a public speaker and health activist. Contact her at rainfordcorcoran@gmail.com

MONTANA RANCH PROPERTIES

AGRICULTURE | CONSERVATION | LAND | SPORTING



Bridger Canyon Masterpiece, Bozeman

DON PILOTTE, BROKER | 406.580.0155 | RANCHMT.COM



\$7,800,000 | #183385

Bridger Canyon Masterpiece

40.24± acres, 4 bd, 8 ba, 10,923± sf home, 5 fireplaces, wine room, home theater, bar, Incredible craftsmanship and attention to detail



\$3,995,000 | #199289

Diamond Bar 7, Big Timber

2,062± acre productive ranch, 5 reservoirs, irrigated cropland, owner’s residence, hand’s home & live water



\$778,000 | #200670

Lost Trail Retreat, Big Sky

20± acres, mid-mountain location Outstanding building site with mtn views Community water system



BERKSHIRE HATHAWAY
HomeServices

Montana Properties

© 2014 BHH Affiliates, LLC. An independently owned and operated franchisee of BHH Affiliates, LLC. Berkshire Hathaway HomeServices and the Berkshire Hathaway HomeServices symbol are registered service marks of HomeServices of America, Inc. ® Equal Housing Opportunity.

CONSIGNMENT CABIN OF BIG SKY



Selling lightly used, upscale, quality goods from the home !

NOVEMBER SALE!

**20% OFF Entire Rug Inventory • 30% OFF All Baskets
Up to 40% OFF Select Furniture**

Always On-Going 10%-50% OFF
Select Men’s, Women’s, Children’s Clothing

Now Under New Ownership!

Call Kerri and Kevin Fabozzi 406-993-9333

Open 6 days/week
Monday-Saturday 10am - 5pm
CLOSED SUNDAY

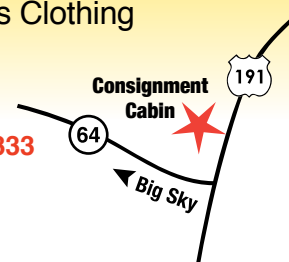

Luxury Property Collection

Featuring:

PRICE REDUCED



Luxury Suite 1B*
Moonlight Basin
3bedrooms, 3.5 bathrooms
2,563 SQ FT.
Ski-in, ski-out
\$1,490,000



2535 Ousel Falls Road*
Spanish Peaks Mountain Club
5 bedrooms, 5 bathrooms
4,701 SQ FT. / 3.09 ACRES
Surrounded by open space
\$2,950,000



214 W. Pine Cone Terrace
Aspen Groves
4 bedrooms, 3.5 bathrooms
4,268 SQ FT.
End of cul-de-sac location
\$1,500,000

NEW LISTING

Treehouse WML #206 / Yellowstone Club*
4 bedrooms, 4 bathrooms / 2,191 SQ FT. / \$11,500,000
Rare opportunity to own slopeside in the Warren Miller Lodge

L&K

Real Estate Brokerage, Consulting & Development

406-995-2404 • LKREALESTATE.COM



All information given is considered reliable, but because it has been supplied by third parties, we cannot represent that it is accurate or complete, and should not be relied upon as such. These offerings are subject to errors, omissions, and changes including price or withdrawal without notice. All rights reserved. Equal Housing Opportunity. If you currently have a listing agreement or buyer broker agreement with another agent, this is not a solicitation to change. ©2015 LK REAL ESTATE, LLC. lkrealstate.com * Membership upon invitation or approval

Celebrate Wild Rivers!

License plates on sale now



American Rivers
Rivers Connect Us®
www.americanrivers.org

Jim Klug photo

WINTER CAMP SCHOLARSHIP PROGRAM



Women In Action is offering scholarships to boys and girls aged 3 - 15 who want to attend winter ski schools at Big Sky Resort. Scholarships for equipment rental are also available.

Scholarships are based on financial need.

For more information on available classes, go to:

www.bigskyresort.com/the-mountain/mountain-sports-and-lessons/youth-local-programs

APPLICATION DEADLINE IS DECEMBER 4, 2015!

Please fill out an application and mail to:

WIA Winter Ski School Scholarships

PO Box 161143

Big Sky, MT 59716

Applications are available at:

- Big Sky School
- Morningstar Learning Center
- WIA's website—www.wiabigsky.org



**WOMEN
IN ACTION**

ENRICHING THE LIVES OF FAMILIES

INFO@WIBIGSKY.ORG

(406) 209-7098

DOCTOR'S NOTE

Understanding food allergies, sensitivities



BY DR. JEFF DANIELS
EBS MEDICAL COLUMNIST

Reactions to food, ranging from insignificant to life threatening, are more common in the U.S. than ever. From indigestion to anaphylactic shock, these health effects are changing the way we consider, eat and handle food.

As a former allergist, I'll admit that food allergies and sensitivities are some of the most puzzling, difficult to diagnose, and difficult-to-treat problems I've dealt with. Some people have life-threatening reactions, while myriad food faddists, food sensationalists, and others label themselves "allergic."

Many health professionals, for one reason or another, misdiagnose people as being allergic to certain foods. Testing isn't exact and misconceptions about the complexities of real conditions are often difficult to understand. Also, many people who feel poorly latch on to a diagnosis of a food allergy or sensitivity because it makes them feel psychologically better.

Take for example gluten sensitivity and intolerance. Gluten is a composite protein – made up of gliadin and glutenin – found in wheat, rye and barley. A small but significant percentage of the U.S. population – between 0.5-1 percent, or up to 3 million Americans – can develop severe gastrointestinal problems by eating foods containing gluten. There are also dermatologic and neurologic conditions blamed on an immune reaction to this common protein. These are people with real gluten sensitivity.

A common diagnosis made in the U.S. is gluten intolerance, a condition with a diverse set of symptoms. A lab test is often used to confirm that antibodies are being produced against gluten. As many as 30 million people in the U.S. call themselves gluten intolerant, yet there are no scientific data to confirm that gluten is hurting them at all. Since a gluten-free diet is the only treatment for all of these conditions, the gluten-free food industry is thriving.

People can be desensitized to pollen, animal dander, and even insect sting allergies, but there are no successful treatments for food sensitivity. Luckily, for food allergies other than peanuts – which is more complex than other food allergies – most people will lose their sensitivity over time, stop having bad reactions, and start enjoying the food that at one time might have killed them.

Aside from avoiding any offending food – a daunting task when it comes to certain things, such as peanuts – the only treatment available are medications to reverse an allergic reaction. The most efficacious of these is epinephrine – also known as adrenalin – which most people have in a device called an EpiPen. Since epinephrine has to be administered via needle, EpiPens make it easy, and have saved many lives. Other medications we use include Benadryl and prednisone.

Most people and businesses are now "sensitive" to those with food allergies. In many restaurants, if a person claims he or she is allergic or sensitive to a food, a clean set of utensils, pots, and plates are used to prepare and serve the meal. It puts pressure on the kitchen staff, wait staff and management, but it can avoid disaster.

Dr. Jeff Daniels has been practicing medicine in Big Sky since 1994, when he and his family moved here from New York City. A unique program he implements has attracted more than 700 medical students and young doctors to train with the Medical Clinic of Big Sky.



MEDICAL CLINIC OF BIG SKY
AFTER-HOUR EMERGENCY CARE & IN-HOUSE X-RAY MACHINE

**URGENT CARE
&
FAMILY PRACTICE**

Expert Internal
and Sports Medicine •
Personalized Family Care

Jeff Daniels, MD | Cary Wilson, PA-C

Mountain Village & Meadow Town Center | 406.995.2797 | Open 10-5 daily

MEDICALCLINICOFBIGSKY.COM



**Big Sky
SUGARBUZZ**
CANDY & SODA

Located in Westfork Meadows

81 Snowy Mountain Circle, Big Sky, MT • (406) 993.2255

 @bigskysugarbuzz  Big Sky SugarBuzz

This is how Big Sky gets into hot water.



Nordic Hot Tub
We service what we sell!

Spa sales to fit your budget
Pool and spa care after the sale
Custom maintenance plans

Spa covers and custom lifts
Lots of accessories for your spa
Special orders available

www.BigSkyHotTubs.com

(406) 995-4892 • NordicHotTub@aol.com
47520 Gallatin Rd. • Big Sky, MT 59716

Pollinating an economic boom

For beekeepers, there's money in almonds despite colony losses

BY MARIA WYLLIE
EBS CONTRIBUTOR

Beginning in November each year, Montana beekeepers load thousands of honeybee hives on flatbed trucks and migrate to California's Central Valley for the coming almond pollination, a major event in commercial beekeeping.

The Golden State has a virtual monopoly on the crop, producing approximately 80 percent of the world's almonds, which require pollination by 1.6 million – more than half – of America's bee colonies. This means big business for beekeeping states like Montana, which ranked fourth in honey production in 2014 and is home to about 160,000 colonies.



33%

OF GLOBAL FOOD PRODUCTION VOLUME RELIES ON POLLINATORS TO SOME DEGREE

Without the help of honeybees, we wouldn't have almonds – a primary reason the insect's declining health is raising eyebrows. It's been a topic of debate since 2006, when beekeepers started seeing significant colony attrition in the U.S., suffering an average annual loss of 32 percent.

Some beekeepers attribute these fatalities to Colony Collapse Disorder, a phenomenon occurring when a hive's worker bees mysteriously disappear, but the queen remains. However, CCD itself is quite rare, according to Cam Lay, Natural Resource Program Manager for Montana's Department of Agriculture.

"Usually when a hive dies, you can tell why," says Lay, who inspects apiaries – or collections of beehives – and issues health certificates allowing companies to bring their bees into California for pollination services, and then back to Montana where they're based.

Instead, high annual bee losses usually result from a complex variety of factors ranging from poor bee management and nutrition, to pathogens and agrochemical exposure. But a definitive cause is up in the air.

"The real answer is we still don't know," said Michelle Flenniken, an assistant professor at Montana State University's Department of Plant Sciences and Plant Pathology. For one study, Flenniken and her team are examining the role of pathogens – including viruses, bacteria, parasites and fungi – on honeybee health before, during, and after almond pollination.

"You really need to know what pathogens are present before you can correlate any of them with colony loss," Flenniken said.

Despite these losses and recent reports claiming bees are in dire straits, honeybees are not facing extinction and our nation's food supply is not running out. Beekeepers are actually doing well because, right now, there's money in bees.

An almond has two primary needs: water and honeybee pollen. Approximately one gallon of water is needed to grow a single almond, a problem for California's drought-ravaged agricultural landscape. Because honeybees are the only pollinators, almond growers pay the highest rental fees for their services, consequently dictating much of what happens in commercial beekeeping.

"All the commercial guys migrate [to California]," Lay said. "They can't afford not to."

Greg Fullerton, president of the Montana State Beekeepers Association and owner of Glacier County Honey in Babb, Montana, says the almond industry is a central reason why people are running so many hives right now. He points to poor management practices as a reason for colony losses, and says some beekeepers are losing colonies because they're raising more bees than they can handle.



Michelle Flenniken inspects a frame of bees from a colony at a research farm on MSU's campus in Bozeman. PHOTO BY KELLY GORHAM

"It's like overgrazing cattle," Fullerton said. "It's profitable enough now that everyone's running way more than what I consider their economic threshold."

According to the United States Department of Agriculture, honeybees, which are designated as specialty crops at the state and federal level, provide \$15 billion annually in agricultural products including honey and pollination services.

Glacier County Honey is a small-scale operation, cultivating approximately 1,600 colonies and working on a hive-to-hive basis rather than running up the numbers. By



comparison, many of the bigger commercial companies are running multiple thousands of hives but don't have the resources to adequately manage them, according to Fullerton.

"I don't think the bees are completely dying across the country, and [that] we're going to be without," he said.

A second-generation beekeeper, Fullerton says his family saw a mere 2-3 percent loss of bees in the 1980s and '90s. Now he sees 25 percent losses annually – a decline he believes is a consequence of increased stresses, such as new mites, pesticides and frequent migration.

Still, Fullerton doesn't believe the bees are disappearing anytime soon. He and other apiarists cut their losses by splitting one colony into two and adding an extra queen. This is typically done right before almond pollination so the required 1.6 million colonies are ready to go.

Splitting hives enables beekeepers to meet the soaring demand for almonds, as well as more than 130 other crops pollinated by honeybees such as citrus fruits, alfalfa, and canola oil. The technique has also kept the average number of bee colonies in the U.S. at 2.5 million – a figure that hasn't changed much since 2006, even when considering the 32 percent average annual loss.

HONEYBEES CONTRIBUTE

\$15 BILLION

TO THE VALUE OF U.S. CROP PRODUCTION ANNUALLY

"The business has continued to thrive," Fullerton said. "Beekeepers are doing quite well."

But Flenniken says splitting hives to meet demand is a poor method of balancing bee attrition. "If you think of honeybees like any other agricultural crop, we would not tolerate a 32 percent annual loss," she said.

Increasing losses are also requiring beekeepers to work harder to maintain their hives. This compromises many of the foods we rely on for a solid, nutritious supply – a major reason why the Almond Board of California supports ongoing honeybee research, according to the group's website.

The 2014 Almond Almanac states that the 2013-14 almond-crop year achieved the highest overall shipments and the second highest production level by almond growers worldwide. The U.S. market set a record for the eighth consecutive year, with shipments up 9 percent over 2013, at 641.8 million pounds.

The \$6.4 billion industry couldn't exist without honeybees, and if demand for almonds – one of the world's favorite snacks – increases as expected, it remains to be seen if the honeybee supply can keep up, even when splitting hives.

Consequently, while the bees aren't likely to disappear, the cost of pollination services will rise. This means food prices will go up, and you'll either find a new go-to snack, or pony up for almonds.

This article was adapted from one originally published in the summer 2015 edition of Mountain Outlaw magazine.

NUMBER OF U.S. HONEYBEE COLONIES

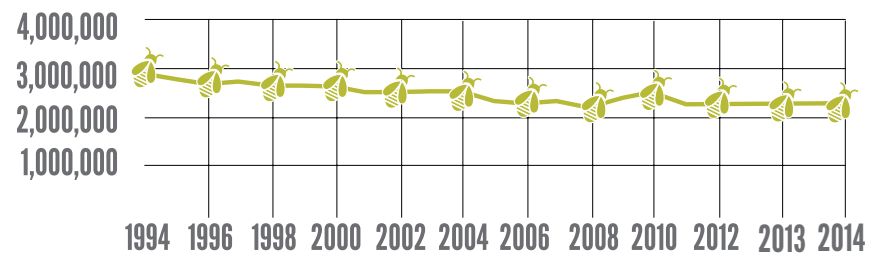

32% AVERAGE ANNUAL COLONY LOSS SINCE 2006

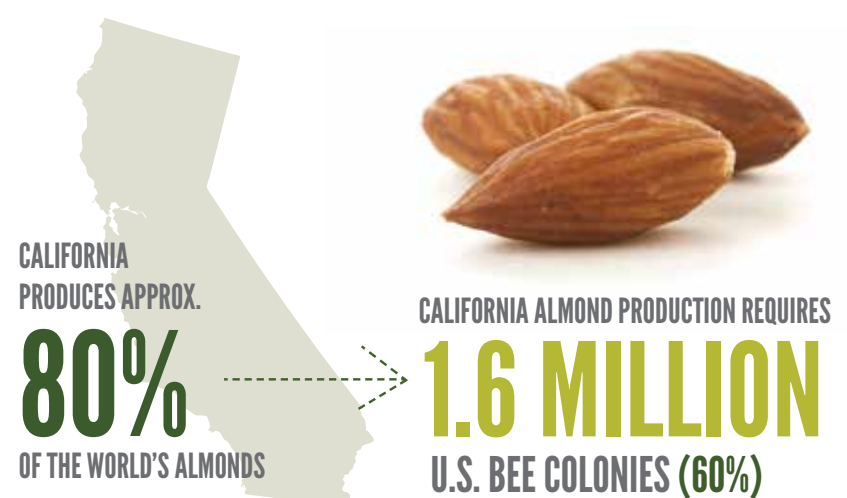

CALIFORNIA ALMOND CROP YEAR RECORDS

2013/14

- HIGHEST OVERALL SHIPMENTS EVER
- 2ND HIGHEST PRODUCTION LEVEL
- SHIPMENTS UP 3.8% AT 1.94 BILLION LBS.



GLOBAL SHIPMENTS ALMOND CROP YEARS 2006-2014

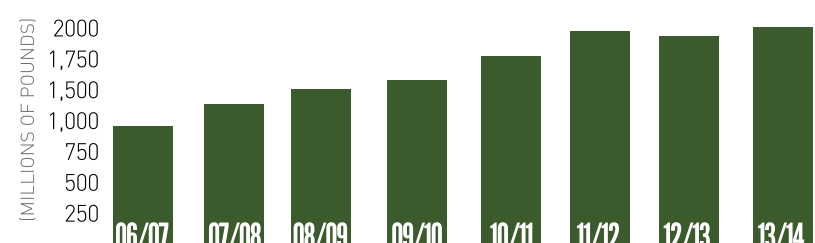

SOURCES: U.S. DEPARTMENT OF AGRICULTURE, 2014 ALMOND ALMANAC MONTANA STATE UNIVERSITY

WORKSHOPS & SPECIAL EVENTS



SKI CONDITIONING
YOGA CLASSES

Monday evenings, Tuesday & Thursday mornings

NOV. 11, 7:00-8:00

Creative Writing Circle with
Liz McRae

CHECK OUT OUR SPECIAL SUNDAY
EVENINGS: DANCE, QI GONG AND MORE
santoshabigsky.com

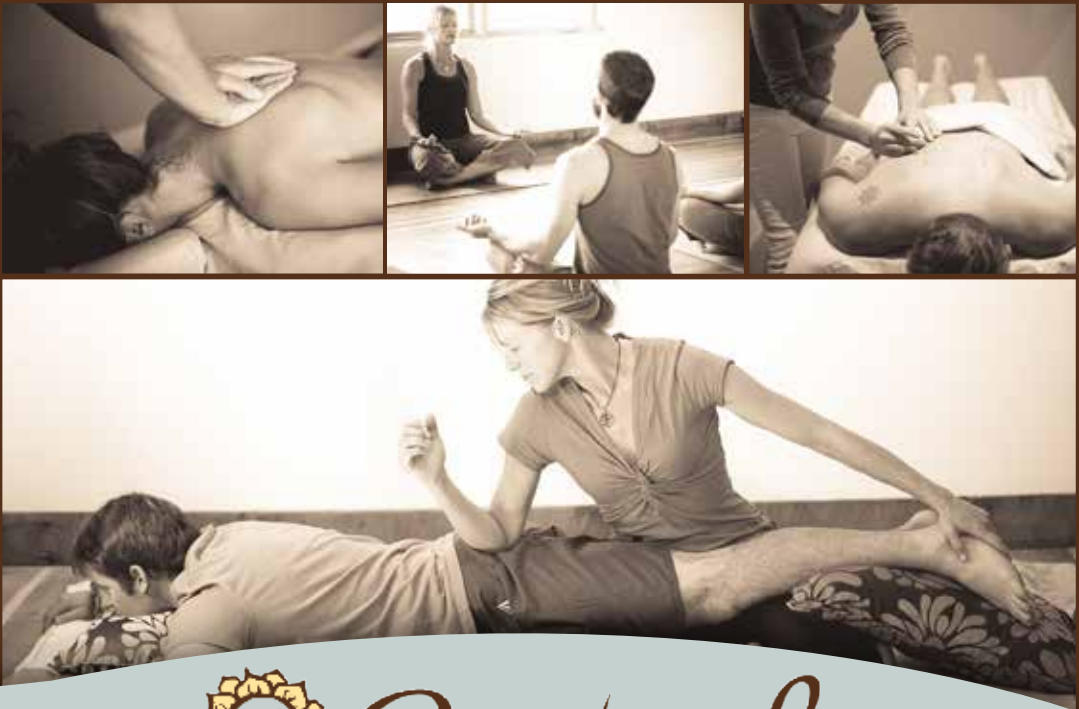

Bringing you closer to Santosha (contentment) today...

YOGA
MASSAGE
ACUPUNCTURE

CHIROPRACTIC
AYURVEDA
THAI MASSAGE



406-993-2510 • 169 Snowy Mountain Circle • Big Sky, Montana

SANTOSHABIGSKY.COM

SUNDAY

10-11am
Adult Ballet

6-7:15pm
(See website for
class details)

MONDAY

9-10:15am
All Levels Yoga

4:15-5:15pm
Yoga for Kids
(9th-12th grade)

5:45-7pm
Ski Conditioning Yoga

TUESDAY

7-8am
All Levels Yoga

8:15-9:15am
Core Focused Pilates

9:30-10:45am
Ski Conditioning Yoga

4:15-5pm
Yoga for Kids
(5th-8th grades)

WEDNESDAY

7:30-8:30am
All Levels Yoga

9-10:15am
All Levels Yoga

11/11
Awareness
Wednesday
7-8pm

THURSDAY

7-8am
Zumba

8:15-9:15am
Roll it Out Pilates

9:30-10:45am
Ski Conditioning Yoga

FRIDAY

8:30-9:30am
Level II Yoga

10-11:30am
The Practice

3:15-4pm
Yoga for Kids
(3rd-5th grades)

4:15-4:45pm
Yoga for Kids
(K-2nd grades)

SATURDAY

9-10:15am
Ashtanga Flow



**FRESHLY ROASTED ON THE
EDGE OF YELLOWSTONE**

Coffees, Candies, Specialty Goods, Gifts



Find our coffees throughout Yellowstone National Park
or visit our roastery at 129 Dunraven Street, West Yellowstone, MT
morningglorycoffee.net | facebook.com/MGCTwest



PHOTO: AUDREY HALL

GENERAL CONTRACTING, TIMBER & CABINET WORKS

OSM

ON SITE MANAGEMENT
THE CONSTRUCTION COMPANY

BOZEMAN, MT 406.586.1500 | JACKSON, WY 307.733.0733
ONSITEMANAGEMENT.COM

We Use
Organic & Local
Whenever Possible.



**VOTED
Big Sky's
Best!**
4 YEARS IN A ROW!



lotuspad
ASIAN CUISINE

(406) 995.2728
Call for Reservations, Take-Out,
Catering & Private Parties.
In the Westfork Plaza, Meadow Village, Big Sky.
  www.lotuspadbigsky.com

Section 3:
EVENTS & ENTERTAINMENT,
OUTDOORS



For the love of beer

Fifth annual Beer Fest in West

STORY AND PHOTOS BY TAYLOR-ANN SMITH
EBS GRAPHIC DESIGNER

WEST YELLOWSTONE – Breweries and beer lovers gathered on Oct. 17 at the West Yellowstone Holiday Inn to celebrate craft beer. During the fifth annual Beer Fest in West, participants tasted unlimited samples from 14 breweries and two distilleries, while enjoying classic German cuisine and local music.

While most of the vendors hailed from Montana and Wyoming, Upslope Brewery from Boulder, Colo., and Cincinnati's Angry Orchard Cider brought new faces and flavors to the mix.

Montana breweries in attendance included Big Sky Brewing Co., Red Lodge Ales, Lewis & Clark Brewing Company, Outlaw Brewing, and Madison River Brewing Co. Everything from smooth golden ales to bock lagers to seasonal specialties were available to sip out of a special tasting stein that came with event entry.

New to this year's event was the addition of the "HomeBrew Fest in West" competition. Home brewers poured their best beer in various categories including pale ale, Scottish ale, stout/porter, IPA, and spiced, vying for a \$250 beer kit gift card. Nicholas Matulich took home first place with his pale bitter European beer named Rheinart; Chris King came in second for his spiced Mayan Porter; and Derek Wolf placed third with his aptly named Scottish ale, Great Scott.

For those hoping to try some award-winning brews, there was no shortage at Beer Fest. Madison River took home a gold medal in early October for its Cold Smoke Scotch Ale at the prestigious Great American Beer Festival in Denver.

In 2014, Draught Works won very small brewery and very small brewing company brewer of the year at GABF. The Missoula-based brewery also took home the gold last year for their American-style strong pale ale called Scepter Head IPA.

Across the venue from Draught Works was another notable award winner: Jackson, Wyo.'s Snake River Brewing Co. At the 2010 GABF, Snake River received a silver medal for their small-batch brew Rolling Thunder Dortmunder. Derek Beardsley, the brewery's director of sales, said this traditional lager emulates those found in Dortmund, Germany, and explained why Beer Fest in West is a must-attend event for his company.

"While we may be in Jackson, Yellowstone is our backyard and we love the opportunity to share our beer with everyone," Beardsley said.

Accompanying libations were pretzels and mustard cheese dip, bison brats topped with sauerkraut, and beer cheese soup. Big Sky bluegrass band Gallatin Grass Project kept the crowd moving before Ennis-based band Fool's Gold closed down the event with classic rock covers.



Beer lovers enjoy the festivities at Beer Fest in West with unlimited samples, free music, and German cuisine.

Greensky Bluegrass to perform Bozeman show

VOOTIE PRODUCTIONS

BOZEMAN – The five members of Greensky Bluegrass have forged a defiant, powerful sound that, while rooted in classic string band Americana, has a fearless, exploratory zeal. On Wednesday, Nov. 11 they’ll bring their energetic, genre-bending sound to Bozeman’s Faultline North.

“There’s this great duality to our band,” says Paul Hoffman, Greensky’s mandolinist, vocalist and songwriter. “We’re existing in a few different places at once: we’re a bluegrass band and a rock band, we’re song-driven and interested in extended improvisation.”

The tension and release between these components – tradition and innovation, prearranged songs and improvisation, acoustic tones and electric volume – is what makes the band so dynamic, in concert and on record.

“We play acoustic instruments, but we put on a rock ‘n’ roll show,” says Greensky’s dobro player Anders Beck. “We play in bigger clubs and theaters, there’s a killer light show, and we’re as loud as your favorite rock band. It’s not easy to make five acoustic instruments sound like this – it’s something we’ve spent years working on.”

Greensky also includes banjoist Michael Arlen Bont and bassist Michael Devol. From their roots in Kalamazoo, Mich., Greensky arrived at their

unique take on the bluegrass tradition by working from the outside in.

“I found bluegrass through the back door, through the Jerry Garcia route,” Beck says, alluding to the late Grateful Dead guitarist and bluegrass musician. “That’s how I got to listening to Bill Monroe and Earl Scruggs. It’s really interesting how many people in our generation got into acoustic music through that channel.”

By playing up to 175 shows a year, mostly in rock clubs and festivals like Austin City Limits, Bonnaroo, Telluride Bluegrass Festival and the New Orleans Jazz and Heritage Festival, Greensky became a word-of-mouth underground sensation. They have cultivated a devoted legion of fans entranced both by the band’s improvisational acumen and the quality of their songwriting.

“Taking chances – and pushing the boundaries of a proud tradition – are what mark

Greensky Bluegrass’ sound, which tips its cap to backwoods-jazz virtuosity while holding on to a rock ‘n’ roll edge,” according to the San Francisco Chronicle.

Greensky will be joined at Faultline North by Philadelphia-based musician Tom Hamilton and his band American Babies, who blend electronica-based improv rock with a passion for songwriting.

Faultline North is located on Gallatin Park Drive in Bozeman. Tickets are available for the 8 p.m. show at Cactus Records and vootie.com.



PHOTO COURTESY OF VOOTIE PRODUCTIONS

Just 25 minutes from Downtown Bozeman

REAL ESTATE FOR THE OUTDOOR ENTHUSIAST.

(406) 284.3200 or GallatinClub.com
20 Acre Gallatin Club Homestead Parcels // Starting at \$175,000

Call Today for Real Estate & Membership Information
3200 Nixon Gulch Road • Manhattan, MT • Real Estate Sales & Concierge 406.284.3200 • GallatinClub.com

BFS brings 'The Second Mother' to Procrastinator Theater

BOZEMAN FILM SOCIETY

Bozeman Film Society joins the Associated Students of Montana State University, MSU's Foreign Language Department and the MSU Office of International Programs to bring a critically acclaimed foreign film to the MSU campus.

"The Second Mother" will be shown Tuesday, Nov. 17 at the university's Procrastinator Theater as part of the "Can the Griz" food drive, a fundraiser for the Gallatin Valley Food Bank.

An excitingly fresh take on some classic themes and ideas, "The Second Mother" centers around Val, a hard-working live-in housekeeper in modern day Sao Paulo, Brazil. Val is perfectly content to take care of every one of her wealthy employers' needs, from cooking and cleaning to being a surrogate mother to their teenage son, who she has raised since he was a toddler.

But when Val's estranged daughter Jessica suddenly shows up the unspoken but intrinsic class barriers that exist within the home are thrown into disarray. Jessica is smart, confident, and ambitious, and refuses to accept the class dynamic, testing relationships and loyalties and forcing everyone to reconsider what family really means.

Rated R, "The Second Mother" will be shown in Portuguese with subtitles, and runs 114 minutes.

Admission is reduced with a food donation to the "Can the Griz" food drive and parking is available south of the Student Union Building, in the lot on the corner of Seventh Avenue and Grant Street.

Visit bozemanfilmsociety.org for more information and a preview of the film.

Madrigal Dinner returns to Buck's T-4

ARTS COUNCIL OF BIG SKY

BIG SKY – The Arts Council of Big Sky is presenting the 19th annual Madrigal Dinner on Thursday, Dec. 3 at 5 p.m. in the Montana Room at Buck's T-4. Many consider this event the traditional opening of the Christmas season in Big Sky.

Tickets for the Madrigal Dinner can be purchased in advance, and the event includes a three-course dinner prepared by the chefs at Buck's, as well as festive music from the Montana State University Montanans, the MSU Brass Quintet and the MSU Chorale.

The evening begins with a no-host bar at 5 p.m., followed by seating for the dinner promptly at 6 p.m., in preparation for the Ceremonial Procession of the Lord and Lady of the Manor and their guests.

Old English customs are themes throughout the evening, featuring the Ceremonial Procession, the Wassail Bowl and Christmas Toast, the Boar's Head Procession and the Flaming Pudding Dessert.

The MSU Montanans serenade guests throughout the event and the MSU Chorale presents a concert finale. The dinner closes with the audience joining the musicians in singing familiar carols. This year marks the 50th annual Madrigal Dinner, produced by the MSU School of Music, and the 19th year the production has traveled to Big Sky.

Please call (406) 995-2742 for ticket reservations. The event usually sells out so tickets are available by advanced reservation only.

The Arts Council of Big Sky is a non-profit organization dedicated to bringing musical and artistic performances to the Big Sky Area.



Great Brews, Great Views.

12+ Beers on Tap
Rotating Seasonals
Delicious Lunch & Dinner



Basically...get here now!
11am-10pm, everyday

406.995.3939
LonePeakBrewery.com
48 Market Place, Big Sky, MT 59716

EVENTS CALENDAR

PLANNING AN EVENT? LET US KNOW! EMAIL MEDIA@THEOUTLAWPARTNERS.COM, AND WE'LL SPREAD THE WORD.

FRIDAY, OCT. 30 – THURSDAY, Nov. 12

***If your event falls between Nov.12 and 27, please submit it by Friday, Nov. 20.**

Big Sky
FRIDAY, OCT. 30
Trivia
Lone Peak Cinema, 8 p.m.

SATURDAY, OCT. 31
Haunted House
Whitewater Inn, 5-10 p.m.

Big Sky Fire Department Halloween Festivities
Big Sky Fire Department, 6-8 p.m.

SUNDAY, NOV.1
Lone Peak Football Sunday
Lone Peak Cinema, 11 a.m.-3 p.m.

TUESDAY, NOV. 3
Chamber Board Meeting
Big Sky Chamber, 8:30-10:30 a.m.

Bingo
Gallatin Riverhouse, 6:30 p.m.

FRIDAY, NOV. 6
Trivia
Lone Peak Cinema, 8 p.m.

SATURDAY, NOV. 7
MSP's 'Fade to Winter' showing
Lone Peak Cinema, 6-8:30 p.m.

SUNDAY, NOV. 8
Lone Peak Football Sunday
Lone Peak Cinema, 11 a.m.-3 p.m.

TUESDAY, NOV. 10
Friends of the Library Used Book Sale
Big Sky Elementary School, 8:30 - 5:00 p.m.

HR Workshop
First Security Bank Conference Center, 11:45 a.m.

Bingo
Gallatin Riverhouse, 6:30 p.m.

WEDNESDAY, NOV. 11
Friends of the Library Used Book Sale
Big Sky Elementary School, 8:30 – 11:30 a.m.

THURSDAY, NOV. 12
Big Sky Job Fair
Buck's T-4, 12-6:30 p.m.

Bozeman
FRIDAY, OCT. 30
Cure For The Common + Kitchen Dwellers
Faultline North, 7 p.m.

Redbrain Halloween
Redbrain Media, 6 p.m.

Downtown Trick-or-Treat
Main Street, 3-6 p.m.

The Sweetbacks
Zebra Cocktail Lounge, 9 p.m.

SATURDAY, OCT. 31
Halloween at Red Chair
Red Chair Café, 11 a.m.

Harvest Festival
Park County Fairgrounds, 6-8 p.m.

Trick-or-Treat on Malloween
Gallatin Valley Mall, 3-6 p.m.

Galloween
Lockhorn Cider House, 12 p.m.

Heaven and Hell party
Bar IX, 7 p.m.
Balboa Tea & Costume Party
Townsend Teahouse, 7 p.m.

Run For Your Life 5K + 10K
MSU Bobcat Stadium, 9:30 a.m. – 2:30 p.m.

Silly Moose Improv Show
Verge Theater, 2-3 p.m.

Bozeman Symphony's Halloween Spooktacular
Willson Auditorium, 2:30-5:30 p.m.

Rocky Horror Picture Show Live
Plonk, 6-10 p.m.

SUNDAY, NOV.1
Ceilidh: Live Scottish music jam
Bridger Brewing, 3-5 p.m.

MONDAY, NOV. 2
Pints with Purpose: Friends of Hyalite
Bridger Brewing, 5 p.m.

TUESDAY, NOV. 3
Pert Near Sandstone
Faultline North, 9 p.m.

Open Mic Poetry
Country Bookshelf, 7-9 p.m.

WEDNESDAY, NOV. 4
Heart of the Valley Benefit
406 Brewing Co, 5-8 p.m.

Music and Mussels
Bridger Brewing, 5:30 p.m.

THURSDAY, NOV. 5
Guest Lecture: Cartoonist Stephen Silver
MOR, 6 p.m.

SOUP for Shorties
The Baxter, 6 p.m.

SATURDAY, NOV. 7
48th Annual Ski Swap
Gallatin County Fairgrounds, 10 a.m. – 6 p.m.

Children's Festival of the Book
Bozeman Public Library, 9 a.m. – 5 p.m.

Homemade Holiday Bazaar
Best Western Plus Grantee Inn, 10 a.m. – 4 p.m.

Zion I
The Filling Station, 9 p.m.

Winter Farmer's Market
Emerson Center, 9 a.m. – 12 p.m.

14th Annual Elise Event
Montana Shakespeare in the Parks, 7 p.m.

Ladyface Fundraiser
Faultline North, 8 p.m.

Silly Moose Improv Show
Verge Theater, 2-3 p.m.

SUNDAY, NOV. 8
48th Annual Ski Swap
Gallatin County Fairgrounds, 10 a.m. – 2 p.m.

Ceilidh: Live Scottish music jam
Bridger Brewing, 3-5 p.m.

MONDAY, NOV. 9
Pints with Purpose: One Montana
Bridger Brewing, 5 p.m.

WEDNESDAY, NOV. 11
Greensky Bluegrass w/ Tom Hamilton's American Babies
Faultline North, 7 p.m.

Music and Mussels
Bridger Brewing, 5:30 p.m.

Livingston & Paradise Valley
FRIDAY, OCT. 30
Halloween Skate Night
Livingston Civic Center, 5:30 p.m.

Woman in Black
Blue Slipper Theatre, 8 p.m.

Milton Menasco & The Big Fiasco
Chico Hot Springs, 9:30 p.m.

SATURDAY, OCT. 31
Moving Sale
Livingston HealthCare, 10 a.m. – 12 p.m.

Woman in Black
Blue Slipper Theatre, 8 p.m.

Milton Menasco & The Big Fiasco
Chico Hot Springs, 9:30 p.m.

Into the Woods
The Shane Center, 8-11 p.m.

MONDAY, NOV. 2

Bluegrass Jam
Katabatic Brewing,
5:30 p.m.

Jon Cheryl
Murray Bar, 5 p.m.

TUESDAY, NOV. 3

Beer for a Cause:
\$1 off first beer if you vote
Katabatic Brewing,
5:30 p.m.

WEDNESDAY, NOV. 4

Russell Smith
Katabatic Brewing,
5:30 p.m.

THURSDAY, NOV. 5

Annick Smith reading
Elk River Books,
7-9 p.m.

Moongrass
Murray Bar, 8 p.m.

FRIDAY, NOV. 6

13th Annual Wine &
Beer Festival
Livingston Depot Center,
6-8 p.m.

Smokestack & The
Foothill Fury
Murray Bar, 9 p.m.

Tucker Down
Chico Hot Springs, 8 p.m.

Into the Woods
The Shane Center,
8-11 p.m.

SATURDAY, NOV. 7

Sadie Locken
Katabatic Brewing,
5:30 p.m.

The Bus Driver Tour
Murray Bar, 9 p.m.

Tucker Down
Chico Hot Springs, 8 p.m.

MONDAY, NOV. 9

Danny Freund, Paul Lee
Kupfer, & Ian Thomas
Murray Bar, 5 p.m.

Bluegrass Jam
Katabatic Brewing,
5:30 p.m.

TUESDAY, NOV. 10

Beer for a Cause:
Operation Warm Coat
Katabatic Brewing,
5:30 p.m.

WEDNESDAY, NOV. 11

Aaron Williams
Katabatic Brewing,
5:30 p.m.

THURSDAY, NOV. 12

Jeremiah & The Red
Eyes
Murray Bar, 8 p.m.

West Yellowstone

FRIDAY, OCT. 30

Senior Lunch
Povah Community Center,
12-1 p.m.

**Halloween Carnival
West Yellowstone
School,
6:30-8:30 p.m.**

SATURDAY, OCT. 31

Fall Family Festival
Community Protestant
Church, 6-8:30 p.m.

**Wild West
Halloween Party
Wild West
Saloon, 8:30 p.m.**

Halloween Spooktacular
The Buffalo Bar, 8 p.m.
- close

WEDNESDAY, NOV. 4

Senior Lunch
Povah Community Cen-
ter, 12-1 p.m.

FRIDAY, NOV. 6

Senior Lunch
Povah Community Cen-
ter, 12-1 p.m.

WEDNESDAY, NOV. 11

Free Entrance Day

Senior Lunch
Povah Community Cen-
ter, 12-1 p.m.

RECURRING EVENTS
Historic Walking Tour
Historic District,
self-guided, daily

**West Entrance
closed to
motorized travel
November 2 –
December 15**



MONTANA'S OWN



**BlueCross BlueShield
of Montana**

With nearly 600 of Montana's very own employees, Blue Cross and Blue Shield of Montana is one of the most loyal employers in town. Since 1940, we've been here when our boys came home from the war, when you first got married, when you had your first baby and when you went through a family health crisis. We've always been here for you. And we pledge we're not going anywhere. We're Montana's own Real Montanans helping you when you need it most. Through it all.

A division of Health Care Service Corporation, a Mutual Legal Reserve Company,
an Independent Licensee of Blue Cross and Blue Shield Association.

Learn More or Enroll Today
bcbsmt.com | 1.800.447.7828



OPEN
7
DAYS

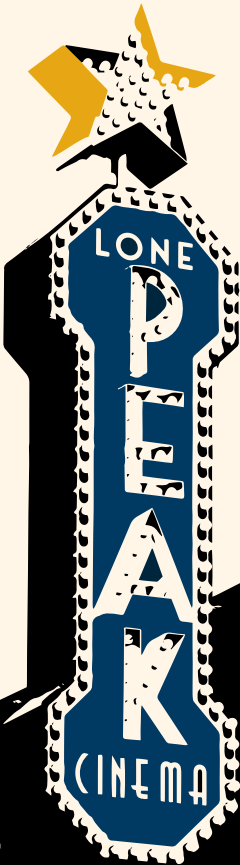

**FULL BAR & LOUNGE!
NIGHTLY HAPPY HOUR
8PM - 9PM**

FOR SHOWINGS & TIMES CALL:
{406} 995.STAR

LOCATED IN THE TOWN CENTER | BIG SKY

LONEPEAKCINEMA.COM

NOW PLAYING

FRI. OCT. 30 - THURS. NOV. 5

- PAN - PG 4:45 & 7:15
- THE MARTIAN - PG-13 5:15
- SICARIO - R 8:15

FRI. NOV. 6 & SUN. NOV. 8-17

- SPECTRE - PG-13 4:00 & 7:15
- THE PEANUTS MOVIE - G 3:45, 6:00, 8:00

SATURDAY NOV. 7TH

- MATCHSTICK PRODUCTION'S "FADE TO WINTER" 6:00 & 9:00
- SPECTRE - PG-13 4:00 & 7:15
- THE PEANUTS MOVIE - G 3:45

EVERY THURSDAY!

FREE MOVIE! 10:30PM 21+

EVERY FRIDAY!

TRIVIA NIGHT 8:00PM

EVERY SUNDAY!

OPEN 11AM - NFL FOOTBALL

EVERY GAME - ALL DAY

FLIP FOR BEER - 11AM TO 3PM

2PM - MATINEES

11/1 PAN & 11/8 THE PEANUTS MOVIE

COMING SOON:

- 11/20 - HUNGER GAMES: MOCKING JAY PT. 2
- 11/25 - WARREN MILLER'S "CHASING SHADOWS"
- 12/17 - STAR WARS EPISODE VII: THE FORCE AWAKENS



THE EDDY Line Trophy trout within reach



BY PATRICK STRAUB
EBS FISHING COLUMNIST

Whether or not we openly admit it, we all want to catch the biggest and baddest trout out there. Watching a fish eat a dry fly is exhilarating, but bringing a 2-foot-long monster to hand is life changing.

Our corner of the fly-fishing world is home to ample water where finding a trophy is possible any day of the year. And during the next few weeks when the weather turns colder, the truly large trout begin foraging in anticipation of the winter months ahead.

Here are some options for trophy hunting this fall, all within a day's drive:

'Land of the Giants.' The Missouri River below Hauser Dam was a secret for a long time. Fished mostly by residents of Helena and Great Falls, and guided by a few tight-lipped outfitters, this short tailwater section is a place where monsters lurk. As more visiting anglers boasted of the river's bounty online, the section became cliché. But is cliché a bad thing when you could catch the biggest trout of your life?

The river here is best fished while drifting with a jet boat, but can also be accessed by foot from Hauser Dam or the Beaver Creek Fishing Access Site. Nymphing will produce large rainbows, but for massive brown trout, fish fully sinking lines and large, weighted flies. Let your fly sink and begin stripping in slowly. I recommend fishing the "Land of the Giants" with a partner – not for safety, but so someone can take the picture.

Yellowstone River near Livingston. As a kid, it was common to hear reports of dozens of people catching 10-pound browns in the fall. I truly believe those fish are still there – I've seen the pictures, albeit much less frequently – they're just harder to catch. And now is the time to get it done.

The conditions of late fall work in your favor because larger brown trout like to hunt in the lower light and they know winter is coming so they bulk-up on baitfish. Heavy sinking lines and large flies are the key if you want to entice the big ones – if you're not tagging the bottom often or your fly is shorter than 4 inches, you might as well be fishing a size 10 dry fly.

Madison River upstream of Hebgen Lake. West Yellowstone's angling forefathers told stories of massive browns emerging from Hebgen Lake.

Today, the fish aren't as large, but they're still prevalent. The trick here is finding a spot – access is easy but good holding water is limited. Fishing here in nasty weather will limit some of the crowds. Get your flies down deep and expect subtle hits. Flies with color such as fire-beads and flash-a-buggers work well.

Blackfoot River and its tributaries. Home to bull trout, Montana's largest river-dwelling salmonid, the Blackfoot River and the valley it courses through is beautiful in fall. The larch trees changing to golden yellow serve up a spectacular backdrop to your late-season fishing. Actively targeting bull trout is not allowed, but the fish are in there and often make meals of a hooked 10-inch cutthroat.

Trophy trout don't come easy. Patience and persistence are necessary, and plane tickets are required for most anglers. However, for lucky folks living in this region, big fish are nearby – if you know how to target them.

Pat Straub is the author of six books, including "The Frugal Fly Fisher," "Montana On The Fly," and "Everything You Always Wanted to Know About Fly Fishing." He and his wife own Gallatin River Guides in Big Sky and Pat operates the Montana Fishing Guide School and the Montana Women's Fly Fishing School.



These next few weeks can yield some of the season's largest trout. The trick is choosing your fishing location wisely. PHOTO BY JIMMY ARMUJO

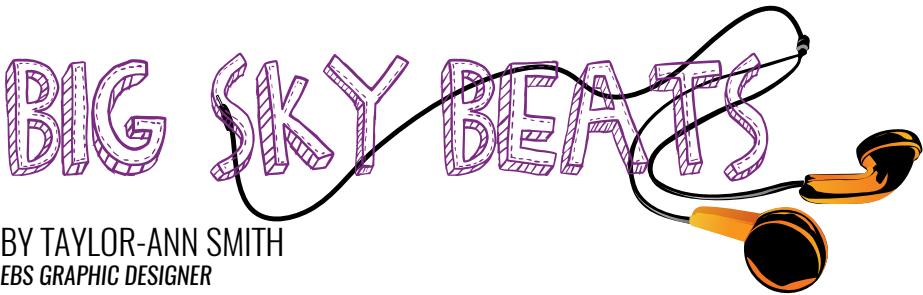

BY TAYLOR-ANN SMITH
EBS GRAPHIC DESIGNER

Find out what tunes we’re bumping! In Big Sky Beats, Explore Big Sky staff offers suggested tracks for your next playlist. Whether you need to freshen up your music library, want to expand your collection, or just need some tunes for the next road trip, we’ve got you covered.

I have an obsession with the United Kingdom, especially its expanding list of chart-topping musicians. You’re probably aware of the classics: The Beatles, Sex Pistols, and Duran Duran, among others. But the U.K. continues to influence the music industry with impactful voices like Sam Smith and catchy sounds from the likes of Duke Dumont.

The increasing popularity of EDM, or electronic dance music, is sparking collaborations between DJs and notable artists such as Justin Bieber or Rihanna, and bringing EDM onto the Billboard charts.

The U.K.’s Calvin Harris, Flux Pavilion, Example, and Chris Lake are among those that have brought electronic music into the mainstream and changed the industry’s sound. This mix of pop and electronica breaks the radio-hit mold and allows the artistry of collaboration to elevate the sound. It’s no longer just the U.S. bringing the beats.

This playlist features some of my favorite British bands and some of the top electronic and pop collaborations:

- 1. “R U Mine?” Arctic Monkeys
- 2. “1996,” The Wombats
- 3. “Chocolate,” The 1975
- 4. “Together feat. Gwen Stefani,” Calvin Harris
- 5. “Latch feat. Sam Smith,” Disclosure
- 6. “Emotional feat. Matthew Koma,” Flux Pavillion
- 7. “Lies,” CHVRCHES
- 8. “Seven Nights Seven Days,” The Fratellis
- 9. “Figure It Out,” Royal Blood
- 10. “Babel,” Mumford & Sons

Visit explorebigsky.com/beats for a sampling of the playlist.

American Life in Poetry: Column 553

BY TED KOOSER, U.S. POET LAUREATE

During World War II the government endorsed the publication of inexpensive paperbacks for persons serving overseas. Jehanne Dubrow, who lives and teaches in Maryland and whose husband is a naval officer, here shows us one of those pocket-sized volumes. This poet’s latest book is “The Arranged Marriage.”

Armed Services Editions

By Jehanne Dubrow

My copy of The Fireside Book of Verse is as the seller promised—the stapled spine, the paper aged to Army tan—no worse for wear, given the cost of its design, six cents to make and printed on a press once used for magazines and pulp. This book was never meant to last a war much less three quarters of a century.

I look
for evidence of all the men who scanned
these lines, crouched down in holes or lying in
their racks. I read the poems secondhand.
Someone has creased the page. Did he begin
then stop to sleep? to clean his gun perhaps?
to listen to the bugler playing taps?

American Life in Poetry does not accept unsolicited submissions, and is made possible by The Poetry Foundation (poetryfoundation.org), publisher of Poetry magazine. It is also supported by the Department of English at the University of Nebraska-Lincoln. Poem copyright ©2015 by Jehanne Dubrow, “Armed Services Editions,” (Bellevue Literary Review, Vol. 15, no. 2, 2015). Poem reprinted by permission of Jehanne Dubrow and the publisher. Introduction copyright © 2015 by The Poetry Foundation. The introduction’s author, Ted Kooser, served as United States Poet Laureate Consultant in Poetry to the Library of Congress from 2004-2006.

CROSSWORD PUZZLE

ACROSS

1 Antiballistic Missile (abbr.)

4 Son of Ruth

8 Heddles of a loom

12 Shaft

13 Dismiss

14 US dam

15 Tier

17 Winglike

18 Chateaubriand heroine

19 Delirium tremens (abbr.)

21 Variation (pref.)

24 Blaubok

28 Time period

31 Ecclesiastic box

33 Abridged (abbr.)

34 Atl. Coast Conference (abbr.)

35 Dismal

36 Beam

37 Before

38 Burden

39 Middle (pref.)

40 Eradicate

42 P.I. tree

44 Gelderland city

46 Viper

50 E. Indian fiber plant

53 Can

56 Open

57 Initial (abbr.)

58 Bronze (Lat.)

59 Languish

60 Rattan

61 Bacon, lettuce, and tomato (abbr.)

ANSWER TO PREVIOUS PUZZLE

J	A	C	A	D	E	C	I	B	A	N
A	D	A	M	E	X	E	A	L	A	E
D	E	M	E	A	N	O	R	L	A	R
E	N	E	P	I	D	A	N	N	E	P
		B	I	M		M	E	A	D	
A	T	A	L	A		N	I	B	L	I
B	A	B	A		W	A	C		I	S
S	O	U	R	S	O	P		S	E	H
		N	E	A	R		I	N	N	
F	A	D		I	N	O	N	U		A
A	G	A	G		O	U	T	B	R	E
L	A	N	A		U	S	E		A	R
A	L	T	I		T	E	R		J	I

DOWN

1 Harp (Ital.)

2 Entice

3 Talking bird

4 Refuse

5 Life (pref.)

6 Slip

7 Title of property

8 Shore

9 Mulberry of India

10 Exclamation

11 Sea (Fr.)

16 Axillary

20 Tree

22 New sugarcane shoot

23 Mountain nymph

25 Berne's river

26 Down with (Fr., 2 words)

27 Freezing (pref.)

28 Bookbinding style

29 Pale brown

30 Maple genus

32 Arabian judge

35 Ran

39 Created

41 Kind

43 Sip

45 Heroic

47 Dull yellowish brown

48 Daredevil Knievel

49 Peace of mind

50 Weaken

51 Silkworm disease

52 Bobbsey twins

54 Genetic letters

55 A (Ger.)

1	2	3		4	5	6	7		8	9	10	11
12				13					14			
15			16						17			
18							19	20				
			21		22	23		24		25	26	27
28	29	30			31		32			33		
34				35						36		
37				38					39			
40			41			42	43					
			44		45		46		47	48	49	
50	51	52			53	54	55					
56					57					58		
59					60					61		

©2015 Satori Publishing

A57



RECYCLE

Enjoy our publication and please remember to recycle.

BACK 40

For Explore Big Sky, the Back 40 is a resource: a place where we can delve into subjects and ask experts to share their knowledge. Topics include regional history, profiles of local artists and musicians, snow and avalanche education, how-to pieces for traditional or outdoor skills, and science.

Noun: wild or rough terrain adjacent to a developed area **Origin:** shortened form of “back 40 acres”

Shade's last hunt

Saying goodbye to a beloved companion

STORY AND PHOTOS BY ASHLEY OLIVERIO
EBS CONTRIBUTOR

Some people say it's a rare animal that can serve as both the perfect hunting dog and a loving family pet. That crossover may be rare, but Shade had it.

The 8-year-old black lab was Jim McEnroe's constant companion since he raised her from a pup, and she retrieved her first bird for him when she was just 5 months old. Well trained and well behaved, you could take her anywhere without a leash and she would follow and obey – except during mealtime, when she lustily gobbled her food.

In McEnroe's work trucks, Shade was his predictable sidekick during their daily rounds in Big Sky, while McEnroe operated his snowplowing and property management business. Running before the horses, dashing ahead on hikes, she lapped around the Spanish Peaks effortlessly.

In August, McEnroe's close hunting buddy Kris Killorn observed that Shade was in the best physical shape of her life. The next week, as she dashed up an embankment to chase a bird, she pulled up lame and backed down to the road. While her spirits still soared, her rear leg began to swell more noticeably each day, and lumps appeared under her fur. Eating became a chore, so we prodded Shade by hand feeding her.

From the first sign of trouble four weeks prior, the transition was alarming. The vet diagnosed her with malignant histiocytosis, a disease characterized by tumors that spread swiftly to organs and joints. It was inoperable and

terminal. Shade now lay listlessly in the yard or the living room mostly, in what appeared to be a slow and miserable descent.

For the past year, we had planned an October pheasant hunt on a ranch near Mott, N.D. So we decided, with life still in her and hope still in us, Shade would go on one final adventure.

We stopped in Glendive, Mont., for a warm-up. Since she could no longer run beside us, we loaded Shade's dog bed into the large plastic toolbox secured to the back of our four-wheeler, and Shade rode with us across the wheat-stubble fields.

When we spotted a grouse gliding into the tall grass, we stopped and McEnroe unloaded Shade. Without him asking, she darted forward and flushed the bird, which fell at one bang of McEnroe's shotgun. Shade half limped, half pranced back to us with the tawny gray prize in her mouth.

In North Dakota, the pheasants teemed on opening day under sunny skies. The members of our hunting party gazed at Shade with pity, her legs swollen and barely able to support her. McEnroe explained her diagnosis but insisted she would join the other dogs on the chase. His assurance was met with skeptical looks.



Shade hunting pheasants with Big Sky's Jim McEnroe in North Dakota this fall.

With our legal limit bulging in our orange vests, we returned to the hunting lodge to share the news of Shade's triumph with our shocked companions. By the following morning, Shade's leg swelling had nearly disappeared, and she ran without an obvious catch in her step. She ate without being coaxed. Maybe it wasn't her last hunt after all, we thought.

Reality is relentless, however. The next day Shade dashed past the ranch's hunting-dog graveyard, its crosses serving as reminders of our only real option: to wring joy out of every minute left on this hunt.

Stopping overnight on our way home to Big Sky, we spent the day pursuing pheasants, and Shade embraced her life's work with unhesitating zeal – she was sharp, alert and enthusiastic.

When we returned home, the sun of our hunting trip was already in eclipse, as McEnroe had to carry Shade in and out of the house. She lost all interest in food; raising her head brought on labored breathing. Her symptoms returned with shocking aggression, and within three days it was over.

A day after Shade died, a longtime hunting friend called and was told the news. He said he was sorry and would miss her. “Shade had a great last hunt,” McEnroe replied. “We all should be so lucky to go out like that.”

We both realized that he wasn't just talking about a dog. And Shade would never be just a dog to us.

Ashley Oliverio is a Big Sky resident and freelance writer. She took up big game hunting this year in Africa and embarked on her first grouse and pheasant hunts this fall with her partner Jim McEnroe.



Shade bringing in her last bird, during her final hunt.